

**CLEVITE**<sup>®</sup>  
ENGINE PARTS

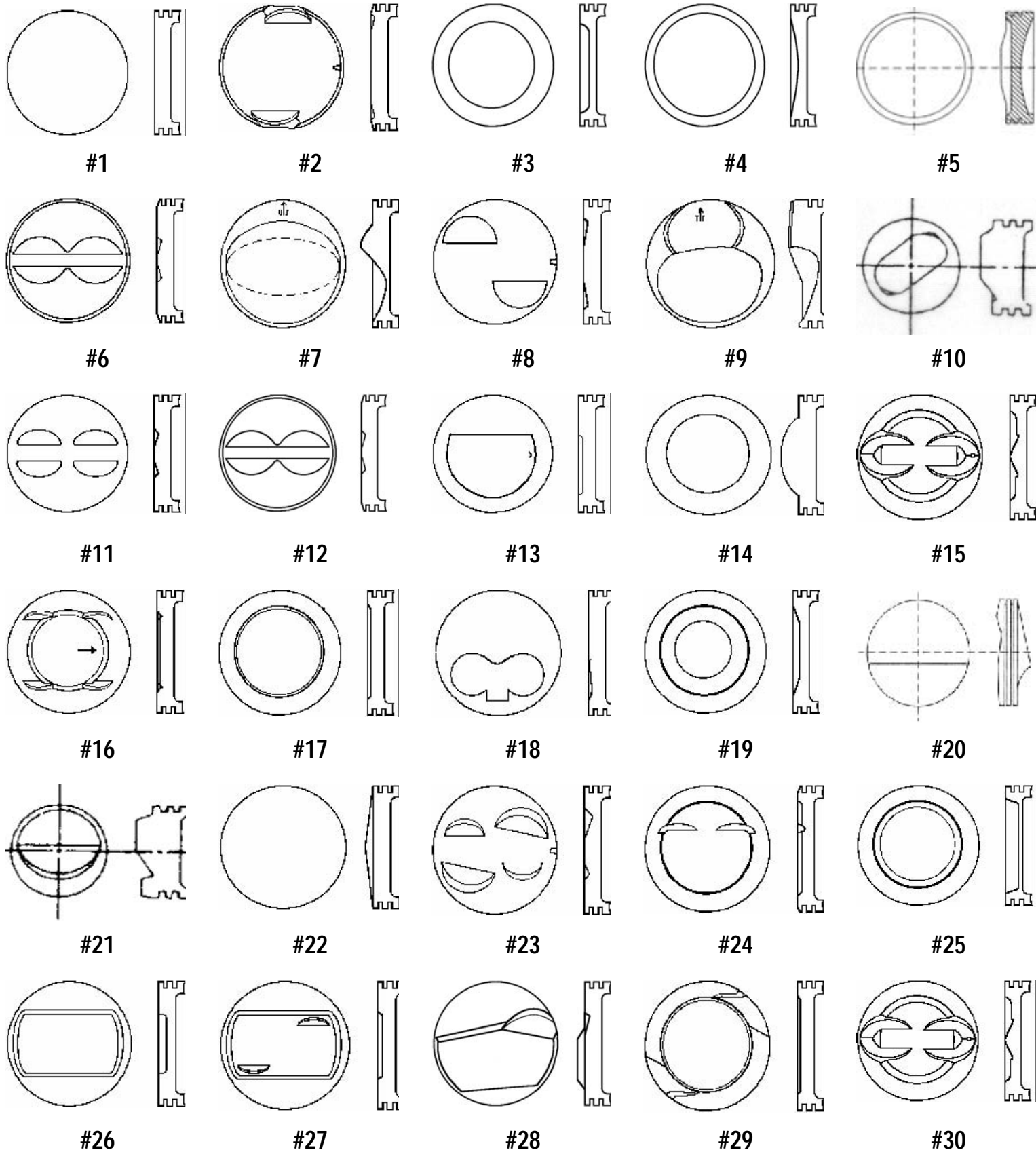

**PISTON  
SPECIFICATIONS**

# Head Configuration Reference Diagrams



# Head Configuration Reference Diagrams

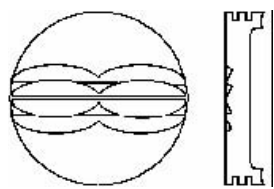

#31

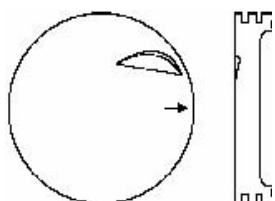

#32

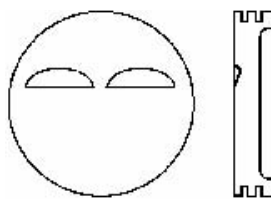

#33

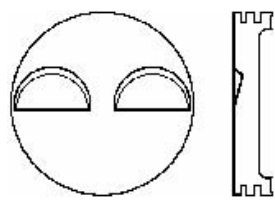

#34

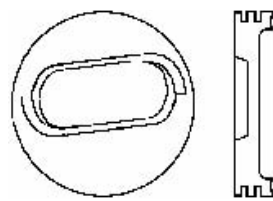

#35



#36

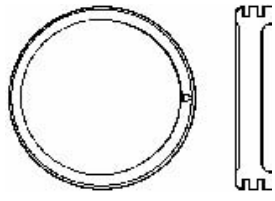

#37

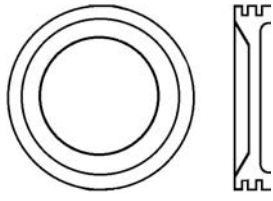

#38

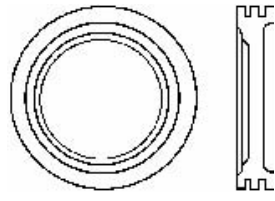

#39

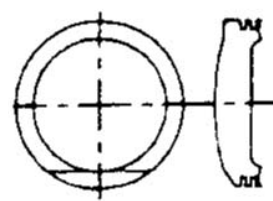

#40

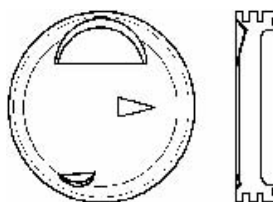

#41

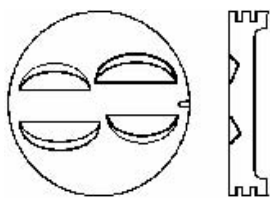

#42

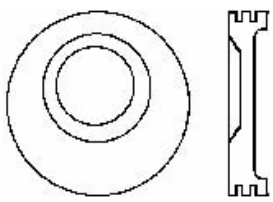

#43

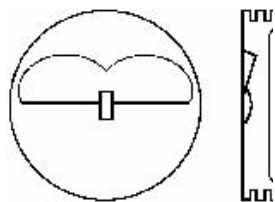

#44

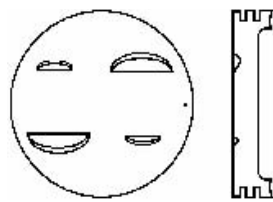

#45

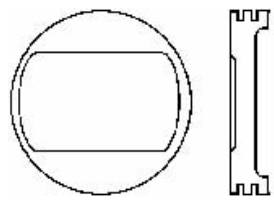

#46

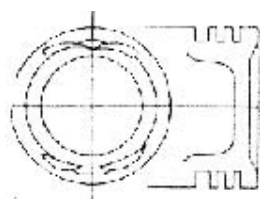

#47

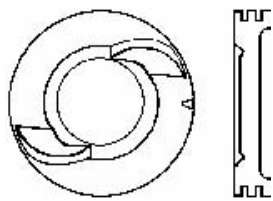

#48

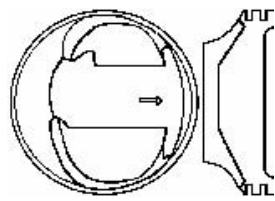

#49

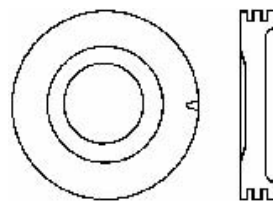

#50

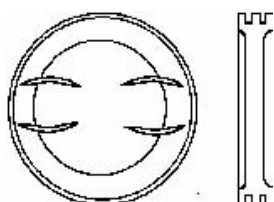

#51

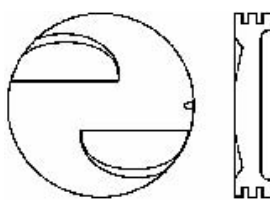

#52

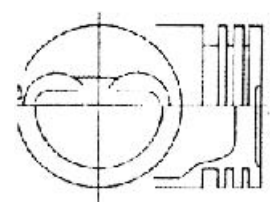

#53

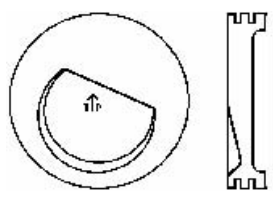

#54

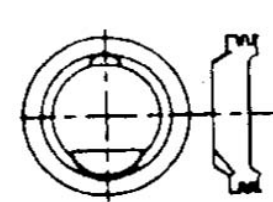

#55

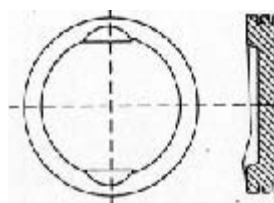

#56

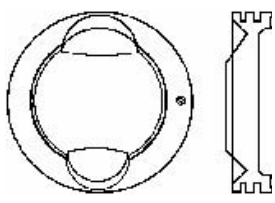

#57

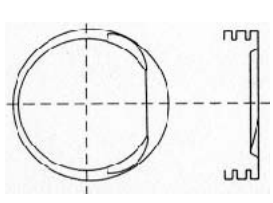

#58

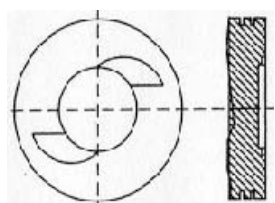

#59

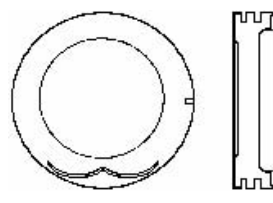

#60

# Head Configuration Reference Diagrams

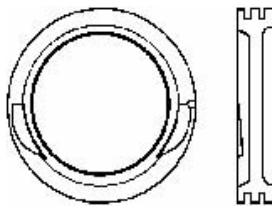

#61

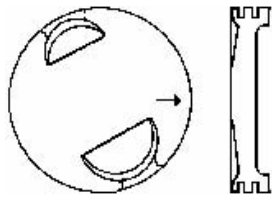

#62

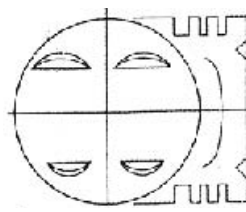

#63

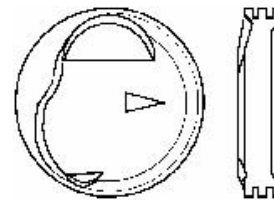

#64

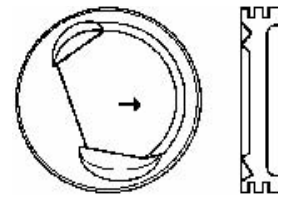

#65

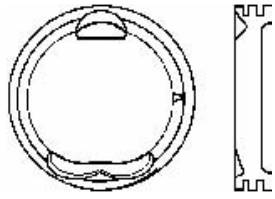

#66

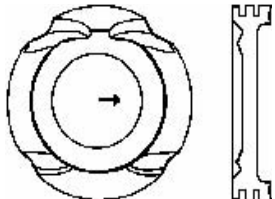

#67

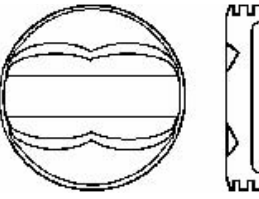

#68

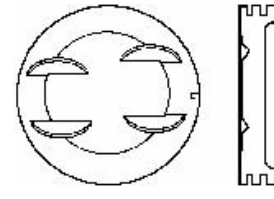

#69

no picture

#70

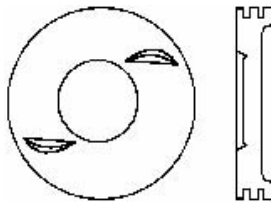

#71

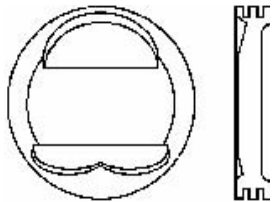

#72

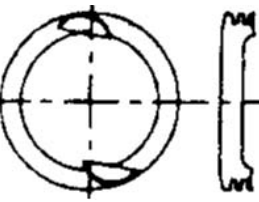

#73

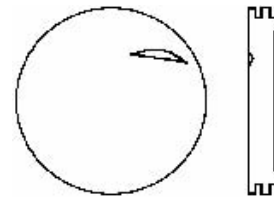

#74

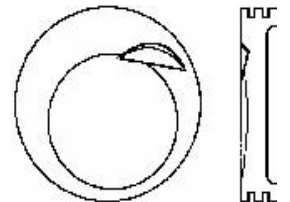

#75

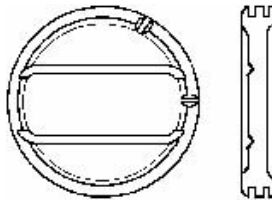

#76

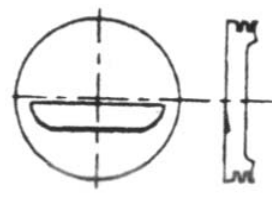

#77

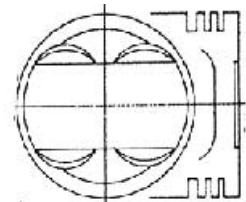

#78

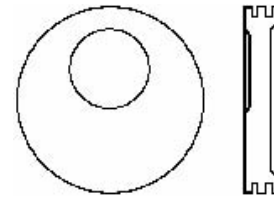

#79

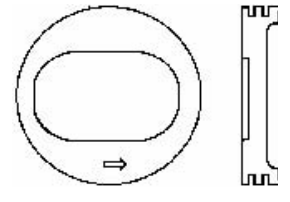

#80

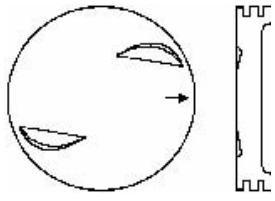

#81

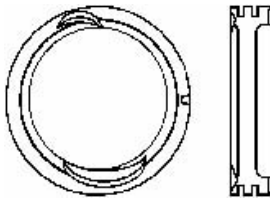

#82

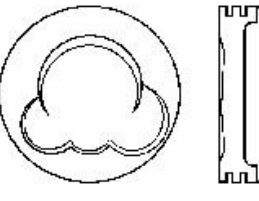

#83

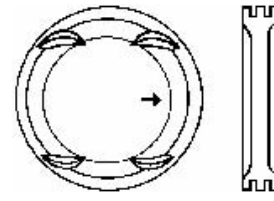

#84

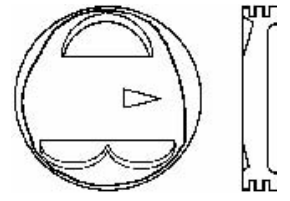

#85

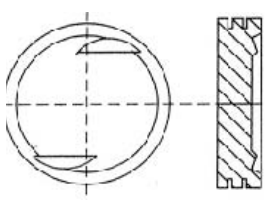

#86

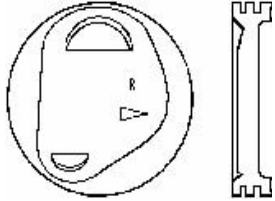

#87

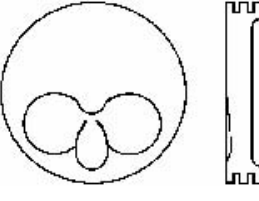

#88

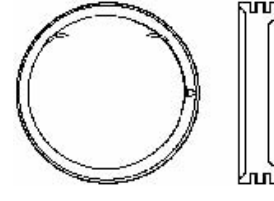

#89

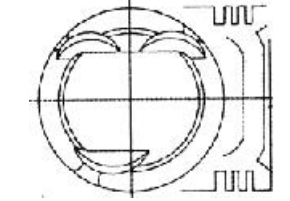

#90

# Head Configuration Reference Diagrams

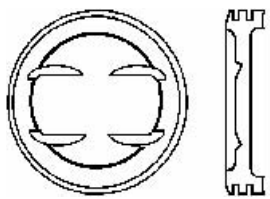

#91

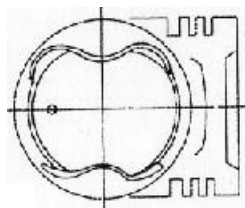

#92

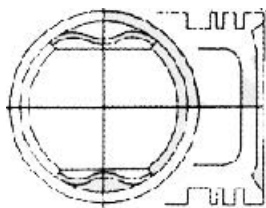

#93

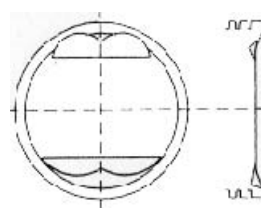

#94

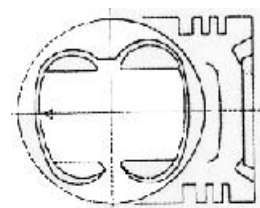

#95

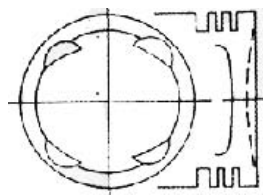

#96

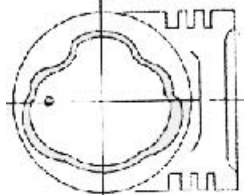

#97

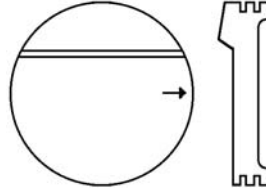

#98

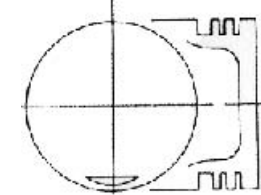

#99

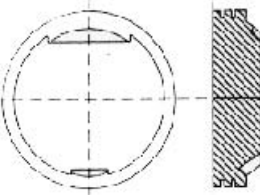

#100

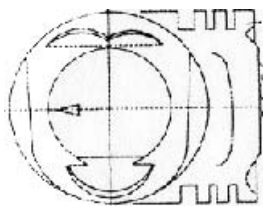

#101

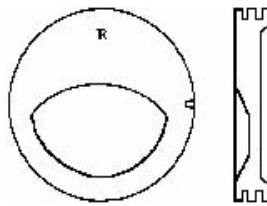

#102

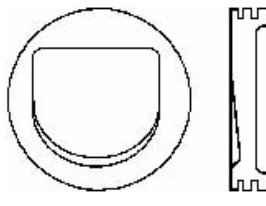

#103

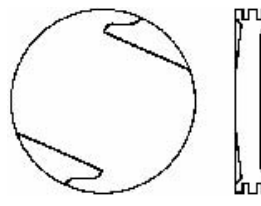

#104

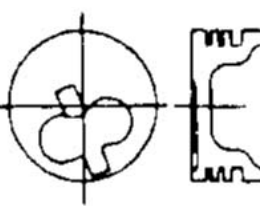

#105

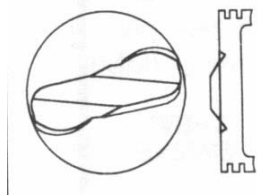

#106

New CEP#	TC #	Set Qty	Bore (in.)	Bore (mm.)	Comp. Ratio	Comp. Height	Piston Length	Pin Diameter	Head Config.	*Mat'l.	Min. Skirt Clearance	Measure Skirt Clearance at:
224-1343	-	-	4.500	114.30	7.2:1	2.72	4.76	1.2199	20	-	.0030	Bottom of skirt
224-1358	-	-	3.910	99.30	8.8:1	1.791	3.20	0.9842	2	-	.0015	.375" up from skirt bottom
224-1397	TC1397	6	3.400	86.40	8.7:1	1.740	3.49	0.9012	1	-	.0015	1.00" up from skirt bottom
224-1408	TC1408	8	4.125	104.80	7.5:1	1.880	3.82	1.094	3	-	.0020	.910" up from skirt bottom
224-1411	-	-	4.250	108.000	7.8:1	2.588	4.40	1.2399	5	-	.0025	top of Skirt Slipper
224-1438	-	-	4.375	111.100	6.5:1	2.310	4.50	1.109	98	-	.0030	bottom of skirt
224-1504	TC1504	6	3.500	88.90	8.45:1	1.580	3.41	0.9122	1	-	.0015	1.00" up from skirt bottom
-	TC1504A	8	3.500	88.90	8.45:1	1.580	3.41	0.9122	1	-	.0015	1.00" up from skirt bottom
224-1526	-	6	3.563	90.50	-	1.784	3.703	0.927	-	-	-	At top of skirt slipper
224-1527	TC1527	8	4.000	101.60	8.7:1	1.654	3.51	0.9273	6	-	.0015	1.00" up from skirt bottom
224-1529	TC1529	8	3.800	78.00	8.4:1	1.580	3.41	0.9122	1	-	.0015	.844" up from skirt bottom
224-1544	TC1544	8	3.875	98.40	varies	1.779	3.78	0.9273	11	-	.0015	1.00" up from skirt bottom
-	TC1544A	6	3.875	98.40	varies	1.779	3.78	0.9273	11	-	.0015	1.00" up from skirt bottom
-	TC1544B	4	3.875	98.40	varies	1.779	3.78	0.9273	11	-	.0015	1.00" up from skirt bottom
224-1563	TC1563	4	3 7/16	87.30	varies	1.998	-	0.8593	1	-	.0020	Bottom of skirt
-	TC1563A	6	3 7/16	87.30	varies	1.998	-	0.8593	1	-	.0020	Bottom of skirt
224-1568	TC1568020	8	3.7500	95.25	8.3:1	1.835	-	0.9398	3	-	.0015	Bottom of skirt
224-1595	TC1595020	8	4.500	114.30	6.9:1	2.468	4.37	1.312	7	-	.0030	.437" up from skirt bottom
224-1602	-	-	4.050	102.90	9.7:1	1.760	3.73	0.9752	91	-	.0015	1.060" up from skirt bottom
224-1650	TC1650	6	3.680	93.50	varies	1.500	3.33	0.9122	25	-	.0015	1.00" up from skirt bottom
224-1658	TC1658	6	3.875	98.40	8.4:1	1.640	3.50	0.9273	13	-	.0015	1.00" up from skirt bottom
224-1666	TC1666	8	4.000	101.60	9.1:1	1.816	3.35	0.9752	6	-	.0015	.312" up from skirt bottom
224-1670	TC1670	8	4.120	104.60	8.2:1	1.700	3.28	0.9805	31	-	.0015	.250" up from skirt bottom
224-1699	TC1699	8	4.250	108.00	varies	1.848	3.78	1.094	1	-	.0015	1.00" up from skirt bottom
224-1701	TC1701	6	4.000	101.60	8.0:1	1.747	3.39	0.9122	13	-	.0025	1.125" up from skirt bottom
224-1708	TC1708	8	3.937	100.00	8.0:1	2.160	3.91	0.9898	74	-	.0020	1.00" up from skirt bottom
224-1712	TC1712	8	4.050	102.90	9.4:1	1.760	3.73	0.9752	15	-	.0015	1.00" up from skirt bottom
224-1713	TC1713	8	4.050	102.90	10.1	1.760	3.73	0.9752	6	-	.0015	1.00" up from skirt bottom
224-1715	TC1715	6	3.750	95.25	varies	1.581	3.35	0.931	13	-	.0015	.750" up from skirt bottom
224-1730	TC1730	8	4.320	109.70	9.5:1, 8.8:1	1.970	3.59	1.094	17	-	.0015	.750" up from skirt bottom
224-1735	TC1735	8	4.1875	106.40	9.9:1	1.942	3.32	0.9997	6	H	.0015	Bottom of skirt
224-1737	TC1737	8	3.875	98.40	8.7:1	1.655	3.51	0.9273	3	-	.0015	.670" up from skirt bottom
224-1740	TC1740	8	4.057	103.00	varies	1.595	3.59	0.9805	25	-	.0015	1.00" up from skirt bottom
224-1746	TC1746	8	4.125	104.80	8.4:1	1.720	3.47	0.9805	3	-	.0015	1.00" up from skirt bottom
224-1747	TC1747	8	4.125	104.80	10.1:1	1.720	3.47	0.9805	11	-	.0015	1.00" up from skirt bottom
224-1749	TC1749	8	3.875	98.40	7.8:1	1.700	3.28	0.9805	-	-	.0015	1.00" up from skirt bottom
224-1795	TC1795	6	4.000	101.60	varies	1.577	-	0.9752	1	-	.0015	1.00" up from skirt bottom
224-1796	TC1796	8	4.1875	106.40	7.5:1	2.019	-	1.094	19	-	.0015	1.00" up from skirt bottom
224-1810	TC1810	8	4.000	101.60	7.65:1	1.739	3.50	0.9122	26	-	.0015	1.00" up from skirt bottom
224-1831	TC1831	8	4.050	102.90	8.2:1	1.660	3.63	0.9752	15	-	.0015	1.00" up from skirt bottom
224-1832	TC1832030	-	4.000	101.60	varies	1.719	3.47	0.9122	23	-	.0015	1.125" up from skirt bottom
224-1840	TC1840	8	4.000	101.60	7.9:1	1.630	3.23	0.9752	29	-	.0015	1.00" up from skirt bottom
-	TC1840A	6	4.000	101.60	7.9:1	1.630	3.23	0.9752	29	-	.0015	1.00" up from skirt bottom
224-1842	TC1842	6	4.000	101.60	8.0:1	1.740	3.67	0.9752	13	-	.0015	pin center line
224-1843	TC1843060	6	4.000	101.60	8.0:1	1.740	3.67	0.9752	13	-	.0015	1.250" up from skirt bottom
224-1845	TC1845	8	4.000	101.60	8.0:1	1.540	3.19	0.9273	24	-	.0015	.750" up from skirt bottom
224-1848	TC1848	8	4.3125	109.50	8.4:1	1.955	3.33	0.9997	3	-	.0020	Bottom of skirt
224-1849	TC1849	8	4.150	105.40	8.0:1	3.070	3.07	0.9805	6	-	.0015	.900" up from skirt bottom
224-1850	TC1850	8	4.000	101.60	varies	1.576	3.16	0.9842	3	-	.0015	pin center line
224-1852	TC1852	8	4.125	104.80	8.5:1	1.540	3.18	0.9273	3	-	.0015	pin center line
224-1856	TC1856	8	4.360	110.70	8.0:1	1.760	3.73	1.04	35	-	.0015	1.20" up from skirt bottom
224-1860	TC1860	8	4.250	108.00	8.0:1	2.160	-	0.9898	32	-	.0025	1.06" from bottom of skirt
224-1863	TC1863	8	4.000	101.60	9.0:1	1.540	3.18	0.9273	33	-	.0015	1.06" from bottom of skirt
224-1866	TC1866	8	4.342	110.30	8.0:1	1.812	-	1.094	1	-	.0015	.850" up from skirt bottom
224-1868	TC1868020	8	4.1650	105.90	8.5:1	1.488	-	1.0007	36	-	.001	.189" from top of Head
224-1869	TC1869	8	4.360	110.70	varies	1.882	3.85	1.04	35	-	.0015	1.125" up from skirt bottom
224-1870	TC1870	8	4.250	108.00	varies	1.627	3.37	0.9898	81	-	.0020	1.00" up from skirt bottom
224-1882	TC1882	8	3.875	98.40	varies	1.830	3.91	0.9752	13	-	.0020	.94" up from skirt bottom
224-1884	TC1884	8	4.125	104.80	8.0:1	1.907	303	1.062	54	-	.0030	Bottom of skirt
224-1885	TC1885	8	4.000	101.60	8.0:1	1.655	3.51	0.9273	84	-	.0020	1.00" up from skirt bottom
224-1889	TC1889	6	3.875	98.40	8.0:1	2.009	3.70	0.9273	13	-	.0025	.500" up from skirt bottom
224-1894	TC1894	8	3.875	98.40	8.2:1	1.891	3.38	1.062	1	-	.0030	Bottom of pin boss
224-1895	TC1895	8	3.875	98.40	8.2:1	2.200	3.69	1.062	9	-	.0030	Bottom of pin boss
224-1907	-	-	4.562	115.90	7.5:1	2.615	-	1.24	4	-	.0030	Bottom of pin boss
224-1915	-	-	3.500	88.90	8.0:1	1.473	3.015	0.9272	1	-	.002	.750" up from skirt bottom
224-1916	TC1916	8	4.000	101.60	varies	1.585	3.34	0.9122	16	-	.0015	1.00" up from skirt bottom

\*H = Hypereutectic

<u>Rings</u>	<u>Notes</u>
3-3/32, 1-3/16	.27" Dome head (not included in Comp. Dist.) Iron Top Groove.
2-5/64, 1-3/16	Flat head w/2 valve reliefs.
2-5/64, 1-3/16	Flat Head
2-3/32, 1-3/16	Recessed Head, Iron Top Groove
3-3/32, 1-3/16	Recessed Head, .12" Deep
2-3/32, 1-3/16	RD450 eng., .125" Step Head, not destroyed, Iron Top Groove
2-5/64, 1-3/16	Flat Head
2-5/64, 1-3/16	Flat Head
2-5/64, 1-3/16	Flat Head
2-5/64, 1-3/16	Flat Head with 4 Valve Reliefs
1-5/64, 1-3/32, 1-3/16	Flat Head
2-5/64, 1-3/16	Flat Head with 4 Valve Reliefs
2-5/64, 1-3/16	Flat Head with 4 Valve Reliefs
2-5/64, 1-3/16	Flat Head with 4 Valve Reliefs
3-1/8, 1-1/4	Flat Head. F162 and F4162 Engines.
3-1/8, 1-1/4	Flat Head. F162 and F4162 Engines.
2-5/64, 1-3/16	3.06" dia. Head recess .23" deep.
2-3/32, 1-3/16	V549 engine. Contoured head, not destroyed. Iron Top Groove.
1-5/64, 1-3/32, 1-3/16	2.687" dia. Head recess 5/64" deep w/ 4 valve reliefs.
2-5/64, 1-3/16	2.25" dia. Head recess .093" deep.
2-5/64, 1-3/16	3" head recess .060" deep.
1-5/64, 1-3/32, 1-3/16	Flat head w/Four valve reliefs
2-5/64, 1-3/16	Piston has 8 valve reliefs for use in either 1st or 2nd type engines.
2-5/64, 1-3/16	Flat head piston replacing both flat head and dished O.E. pistons. Not destroyed when used in 1971 engines.
2-5/64, 1-3/16	Recessed Head .28" deep (For 1965 Thru early 1969-before Chg.L16
1-3/32, 1-5/64, 1-3/16	Trucks, not destroyed. Flat Head w/ one valve relief. Iron Top Groove.
1-5/64, 1-3/32, 1-3/16	3" dia. Head recess 5/32" deep with four valve reliefs.
1-5/64, 1-3/32, 1-3/16	Four valve reliefs. Pin I.D. .700"
2-5/64, 1-3/16	"D" Shaped head recess. .120" deep. Replace in full sets only.
2-5/64, 1-3/16	Flat Head. Replaces both flat head and dished O.E. pistons.
2-5/64, 1-3/16	3.48" dia. head recess .09" deep.
2-5/64, 1-3/16	Flat head w/4 valve reliefs.
2-5/64, 1-3/16	VIN R. 2.92" dia. Head recess .215" deep.
2-5/64, 1-3/16	3.031" dia. head recess .324" deep.
2-5/64, 1-3/16	2.94" dia. Head recess .120" deep.
2-5/64, 1-3/16	VIN P. Flat Head w/4 valve reliefs.
2-5/64, 1-3/16	Flat head. Replaces O.E. piston with recessed head.
2-3/32, 1-3/16	Truck engine. 3-1/4" dia. Head recess 7/32" deep. Iron Top Groove.
2-5/64, 1-3/16	Windsor Eng. Rectangular head recess .227" deep.
1-5/64, 1-3/32, 1-3/16	Car & Trk. Eng. 2-5/8" dia. Head recess 3/32" deep w/4 valve reliefs.
2-5/64, 1-3/16	Windsor eng. Flat Head with 4 valve reliefs. Cyl. Head 60cc=9.3:1
2-5/64, 1-3/16	2-5/16" dia. head recess 1/8" deep w/ 2 angled valve reliefs.
2-5/64, 1-3/16	2-5/16" dia. head recess 1/8" deep w/ 2 angled valve reliefs.
2-5/64, 1-3/16	Trk. Eng. After L16, E or F150-350, P350-500. 3.25" dia. "D" shaped head recess 9/32" (.260") deep.
2-5/64, 1-3/16	Trk. Eng. After L16. 3.25" dia. "D" head recess .28" deep. Iron Top Groove.
2-5/64, 1-3/16	Trk. Eng., Series 40 & 50. 3.500" head recess .140" deep w/2 valve reliefs.
2-5/64, 1-3/16	3.61" dia. Head recess .245" deep.
1-5/64, 1-1/16, 1-3/16	Flat Head w/4 valve reliefs.
2-5/64, 1-3/16	3.13" dia. Head recess .05" deep. Thru 1992 Trks.
2-5/64, 1-3/16	Small Block. 3.46" dia. Head recess .145" deep.
2-5/64, 1-3/16	Car & Trk. non-EFI. .228" deep head recess w/2valve reliefs (20cc head)
1-3/32, 2-5/64, 1-3/16	Trk. Eng. Flat head w/one valve relief. Iron Top Groove.
2-5/64, 1-3/16	Trk. Eng. Series 10 though 30 exc. Light duty. Flat head w/2valve reliefs.
2-5/64, 1-3/16	Flat Head.
2-5/64, 1-3/16	3.530" dia. Head recess .325" deep. V400 Eng.
2-5/64, 1-3/16	Oblong head recess .100" deep with 2 angled valve reliefs.
2-5/64, 1-3/16	Flat Head piston w/2valve reliefs. Used in either left or right bank cylinder banks. For 1970 replace in full sets only.
1-5/64, 1-3/32, 1-3/16	Trk. Eng., medium and heavy duty. 3.218" dia. "D" shaped head recess 5/64" deep. Pin I.D. .700"
2-3/32, 1-3/16	Exhaust Emission engine. Recessed head, not destroyed. Iron Top Groove.
2-5/64, 1-3/16	Trk. Eng. 3-1/4" dia. Head recess 5/64" deep w/2 valve reliefs.
2-3/32, 1-3/16	Trk. Eng. 3.187" dia. Head recess .328" deep.
2-3/32, 1-3/16	Exhaust emission engine. Recessed head, not destroyed. Iron Top Groove.
2-3/32, 1-3/16	Contoured Head, Not destroyed. V345 , V304 , Scout eng. Iron Top Groove.
2-3/32, 1-3/16	3.16" dia. Head recess .375" deep. Hollow pin. Iron Top Groove.
2-5/64, 1-3/16	Flat head. Recommended for use w/sleeved engine only. Chevy Vega.
2-5/64, 1-3/16	2.50" dia. Head recess .156" deep w/4 valve reliefs.

New CEP#	TC #	Set Qty	Bore (in.)	Bore (mm.)	Comp. Ratio	Comp. Height	Piston Length	Pin Diameter	Head Config.	*Mat'l.	Min. Skirt Clearance	Measure Skirt Clearance at:
-	TC1916A	6	4.000	101.60	varies	1.585	3.34	0.9122	16	-	.0015	1.00" up from skirt bottom
224-1921	TC1921	8	4.000	101.60	7.9:1	1.630	3.23	0.9122	29	-	.0015	pin center line
224-1930	TC1930	8	3.910	99.30	varies	1.658	3.36	0.9842	1	-	.0015	.812" up from skirt bottom
224-1946	TC1946	4	3.7795	96.00	-	1.578	2.98	0.9122	8	-	.0015	.65" up from skirt bottom
224-1949	TC1949	8	3.800	96.52	varies	1.805	2.98	0.9398	3	-	.0015	top of skirt
-	TC1949A	6	3.800	96.52	varies	1.805	-	0.9398	3	-	.0015	top of skirt
224-1953	TC1953	4	2.9528	75.00	9.0:1	36mm	-	18mm	1	-	0.04mm	2.48" down from top
224-1973	TC1973	6	3.2677	83.00	varies	1.515	3.06	0.8267	34	-	.0015	.500" up from skirt bottom
224-1976	-	-	3.2677	83.00	varies	1.480	3.06	0.8267	37	-	.0015	pin center line
224-1979	TC1979	4	3.3464	85.00	-	37.740	3.065	21mm	38	-	.0014	3.25" below centerline
224-1999	TC1999	6	3.6614	93.00	8.0:1	1.511	2.87	0.945	1	-	.0015	.450" up from skirt bottom
224-2001	TC2001	8	4.000	101.6	7.9:1	1.921	3.53	0.9752	29	-	.0015	1.00" up from skirt bottom
224-2002	TC2002	-	4.050	102.90	7.2:1	1.902	3.90	0.9752	39	-	.0020	.875" up from skirt bottom
224-2004	TC2004	8	4.050	102.90	7.2:1	1.760	3.656	0.9752	25	-	.0020	1.100" up from skirt bottom
224-2006	TC2006	4	3.307	84.00	8.0:1	1.435	3.14	0.8665	1	-	.0015	.850" up from skirt bottom
224-2007	TC2007	8	3.910	99.30	varies	1.741	3.43	0.9842	11	-	.0015	pin center line
-	TC2007A	6	3.910	99.30	varies	1.741	3.43	0.9842	11	-	.0015	pin center line
224-2009	TC2009	8	4.320	109.70	8.0:1	1.912	3.53	1.094	1	-	.0015	.600" up from skirt bottom
224-2010	TC2010	4	3.1300	-	-	1.642	2.856	0.866	4	-	.0008	.375" up from skirt bottom
224-2012	TC2012	8	3.736	94.90	varies	1.540	3.19	0.9273	3	-	.0015	.95" Up from bottom
-	TC2012A	6	3.736	94.90	8.6:1	1.540	3.19	0.9273	3	-	.0015	.95" Up from bottom
224-2015	TC2015	4	3.0709	78.00	8.3:1	1.455	2.91	0.8665	14	-	.0015	.600" up from skirt bottom
224-2016	TC2016	6	3.3858	86.00	8.3:1	38.3mm	-	21.00mm	3	-	0.04mm	3.25" below centerline
224-2022	TC2022030	8	4.125	104.80	8.0:1	2.200	3.33	1.062	9	-	.0030	pin center line
-	TC2022A030	4	4.125	104.80	8.0:1	2.200	3.33	1.062	9	-	.0030	pin center line
224-2034	TC2034	8	4.000	101.60	8.0:1	1.570	3.27	0.9273	1	-	.0015	.800" up from skirt bottom
-	TC2034B	4	4.000	101.60	varies	1.570	3.27	0.9273	1	-	.0015	.800" up from skirt bottom
224-2035	-	-	4.300	109.00	8.1:1	1.882	3.28	0.9997	1	-	.0010	pin center line
224-2036	TC2036	8	3.500	88.90	varies	1.575	3.60	0.9805	3	-	.0015	1.125" up from skirt bottom
224-2037	TC2037	8	4.125	104.80	8.0:1	1.920	3.41	1.020	25	-	.0020	.700" up from skirt bottom
224-2038	TC2038	8	4.351	110.50	7.9:1	1.595	3.35	0.9805	3	-	.0015	1.00" up from skirt bottom
224-2039	TC2039	6	4.000	101.60	8.8:1	1.763	3.37	0.9752	43	-	.0015	.900" up from skirt bottom
224-2040	TC2040	8	4.000	101.60	8.1:1	1.752	3.35	0.9122	27	-	.0015	1.60" up from skirt bottom
224-2042	TC2042	8	3.500	88.90	varies	1.540	2.98	0.9273	3	-	.0015	.750" up from skirt bottom
-	TC2042A	6	3.500	88.90	varies	1.540	2.98	0.9273	3	-	.0015	.750" up from skirt bottom
224-2047	-	-	2.8740	73.00	-	38.5mm	-	20mm	40	-	.04mm	.375" up from skirt bottom
224-2050	TC2050	4	2.9134	74.00	7.9:1	1.070	2.25	0.6692	3	-	.0015	.75" from bottom
224-2052	-	-	2.9134	74.00	7.9:1	27.6mm	-	17mm	4	-	.04mm	
224-2053	TC2053	4	3.031	77.00	8.8:1	1.063	2.44	0.7087	17	-	.0012	.470" up from skirt bottom
224-2054	-	-	2.8346	72.00	8.1:1	30.0mm	-	17mm	14	-	.01mm	.500" up from skirt bottom
224-2055	TC2055	4	3.307	84.00	8.4:1	1.435	3.13	0.8665	17	-	.0015	1.00" up from skirt bottom
224-2067	TC2067	6	3.500	88.90	-	1.797	2.975	0.940	17	-	.0024	bottom of skirt
224-2073	TC2073	4	3.346	85.00	8.5:1	1.482	3.06	0.8267	4	-	.0015	.800" up from skirt bottom
224-2079	TC2079	4	3.3465	85.00	9.0:1	7.762	3.58	0.8664	100	-	.002	.945" up from skirt bottom
224-2081	-	-	3.7008	94.00	8.3:1	47.6mm	-	25.15mm	14	-	.02mm	.625" up from skirt bottom
224-2088	TC2088	4	3.2283	82.00	8.5:1	1.288	2.660	0.9055	3	-	.0010	.600" up from skirt bottom
224-2093	TC2093	4	3.307	84.00	8.5:1	39.6mm	3.122	22mm	99	-	.0012	3.25" below centerline
224-2099	TC2099	4	2.9134	74.00	8.8:1	29mm	-	18mm	93	-	.01mm	.433" up from skirt bottom
224-2101	TC2101	4	3.484	88.50	8.4:1	1.510	3.39	0.8665	37	-	.0015	1" Up from bottom
224-2108	TC2108	8	4.000	101.60	varies	1.585	3.34	0.9122	42	-	.0015	pin center line
-	TC3055	8	4.057	103.00	varies	1.770	3.36	1.095	44	-	.0035	.700" up from skirt bottom
-	TC3055A	6	4.057	103.00	varies	1.770	3.36	1.095	44	-	.0035	.700" up from skirt bottom
224-2114	-	-	3.012	76.51	23.5:1	1.768	3.027	0.866	18	-		See O.E. repair manual
224-2117	-	-	3.0709	78.00	8.3:1	1.555	-	0.8658	4	-	.0015	.600" up from skirt bottom
224-2120	TC2120	8	4.360	110.70	8.0:1	2.140	3.61	1.040	81	-	.0025	.75" Up from bottom
224-2122	TC2122	8	4.050	102.90	8.0:1	2.120	3.59	1.040	81	-	.0020	.80" up from bottom
224-2123	TC2123	6	3.965	100.70	8.0:1	1.808	2.99	0.9398	3	-	.0015	at bottom of skirt
224-2125	TC2125	4	3.228	82.00	8.6:1	1.474	2.970	0.9055	3	-	.0010	.700" up from skirt bottom
224-2126	-	-	3.800	96.52	8.2:1	2.007	-	0.9996	1	-	.0015	.750" up from skirt bottom
224-2127	TC2127	8	3.680	93.50	8.8:1	1.585	3.12	0.9122	45	-	.0015	.800" up from skirt bottom
224-2128	TC2128	4	3.1875	81.00	8.6:1	1.633	-	0.812	17	-	.001	.700" up from skirt bottom
224-2130	TC2130	6	3.504	89.00	8.5:1	1.578	3.03	0.9055	1	-	.0012	.750" up from skirt bottom
-	TC2130B	4	3.504	89.00	8.5:1	1.578	-	0.9055	1	-	.0012	.750" up from skirt bottom
224-2132	TC2132	8	3.800	96.50	7.9:1	1.595	3.60	0.9805	3	-	.0015	1.00" up from skirt bottom
224-2141	TC2141	4	4.000	101.60	9.0:1	1.570	3.25	0.9273	3	-	.0025	.80" up from skirt bottom

\*H = Hypereutectic



<u>Rings</u>	<u>Notes</u>
2-5/64, 1-3/16	2.50" dia. Head recess .156" deep w/4 valve reliefs.
2-5/64, 1-3/16	Cleveland eng. 2.75" dia. Head recess 1/16" deep, 2 angled valve reliefs.
2-5/64, 1-3/16	Trk. Premium engine. Flat Head, replaces both cup and flat head O.E. pistons
2-5/64, 1-3/16	Flat Head w/2 Valve reliefs. Non-Turbo Courier. Pinto, Mustang II.
2-5/64, 1-3/16	3.05" dia. Head recess .215" deep. Non-Turbo, VIN A.
2-5/64, 1-3/16	3.05" dia. Head recess .215" deep. Non-Turbo, VIN A.
2-2.0mm, 1-4.0mm	Flat Head. K, 3K, 4K engs.
2-2.0mm, 1-4.0mm	Flat Head w/2 valve reliefs. 240Z with L24 eng. 260Z with L26 eng.
2-2.0mm, 1-4.0mm	2.75" dia. Head recess .055" deep. All with L16 eng. U20 eng.
2-2.0mm, 1-4.0mm	Recessed head 3mm deep. L18 eng. 610, 620, 710 OHC
1-2.0mm, 1-2.5mm, 1-4.0mm	Flat Head. Capri and Mustang II.
2-5/64, 1-3/16	2.6" dia. Head recess 0.68" deep w/ 2 angled valve reliefs.
1-3/32, 1-5/64, 1-3/16	2.6" head recess .19" deep. Iron Top Groove. 359/361 trk. Eng. After Engine U40000. 3 ring piston.
1-3/32, 1-5/64, 1-3/16	3" dia. Head recess .31" deep. Trk. Eng. Iron Top Groove.
2-2.0mm, 1-4.0mm	Flat Head. LUV Series 1, 2, 3 & 4.
2-5/64, 1-3/16	Flat top w/4 valve reliefs. 318 cid eng.1973 press fit, no lockrings. Use 1990 and earlier rings. 1991 and later use early style rings.
2-5/64, 1-3/16	Flat top w/4 valve reliefs. 239 cid eng. Grand Cherokee. Fl. Dakota. Availale in fuel injected mid-sized trucks and pickups.1973 press fit, no lockrings.
2-5/64, 1-3/16	Flat Head.
1-1.75mm, 1-2.00mm, 1-4.00mm	Concave Head.
2-5/64, 1-3/16	3.06" dia. Head recess .09" deep.
2-5/64, 1-3/16	3.06" dia. Head recess .09" deep.
2-1.5mm, 1-4.0mm	Dome head .310" high. May be used to replace piston with dished head. Courier 1800cc eng.
2-2.00mm, 1-4.00mm	74.00mm dia. Head recess 3.10mm deep. L28 eng. (To 7-79 on non-usa cars). Press Fit Pin.
2-3/32, 1-3/16	Without Exhaust Emission. Countoured Head. Not Destroked
2-3/32, 1-3/16	Without Exhaust Emission. Countoured Head. Not Destroked
2-5/64, 1-3/16	Flat Head.
2-5/64, 1-3/16	Flat Head. Chevy-Iron Duke. Olds-All 151 engs. in 1978. All VIN 1 w/Calif. in 1979.
2-5/64, 1-3/16	2-1/2" dia. Head recess 1/8" deep. (7cc dish).
2-5/64, 1-3/16	2.35" dia. Head recess .165" deep.
2-3/32, 1-3/16	3.500" dia. Head recess .325" deep. Not destoked. MV404 & MV446 eng.
2-5/64, 1-3/16	3.23" dia. Head recess .146" deep.
2-5/64, 1-3/16	2.4" Dia. Off center circular head recess .30" deep. Trk Eng.
2-5/64, 1-3/16	rectangular head recess .105" deep w/2 valve reliefs, 11.5cc. Windsor Eng.
2-5/64, 1-3/16	2.875" dia. Head recess .125" deep.
2-5/64, 1-3/16	2.875" dia. Head recess .125" deep.
2-2.00mm, 1-4.00mm	Domed head 60.50mm dia, 1.50mm high. TC Eng. SOHC.
2-1.50mm, 1-4.00mm	Recessed head .085". ED1, ED2, ED3, ED4 engs.
2-1.50mm, 1-4.00mm	53mm dia. Recessed head 1.50mm deep. EC & ED eng.
2-1.5mm, 1-4.0mm	2.215" dia. Head recess .054" deep. Accord EK1 eng.
2-1.50mm, 1-4.00mm	65mm dia domed head 2.50mm high. EB2, EB3, EE engines.
2-2.0mm, 1-4.0mm	280" dia. head recess .068" deep. Isuzu-G180Z eng. Chevy-LUV series 5, 6, 8, 9, 10, 11 & 12. Buick-Used in Opel.
2-5/64, 1-3/16	-
2-2.0mm, 1-4.0mm	2.91" dia. Head recess .10" deep. All with L20 eng.
2-2.0mm, 1-4.0mm	.23" Dome included in compresion distance w/2 valve reliefs. For all except engs. Built from 8-74 to 8-76. Use in sets only after 8-77
1-2.00mm, 1-2.50mm, 1-4.00mm	75mm dia.Domed head 6.50mm high. 2F eng.
2-1.5mm, 1-4.0mm	2-3/8" dia. head recess, 3/32" deep. For 1976 replace in full sets only.
2-2.00mm, 1-4.00mm	U, 4G52 eng.Flat head w/1 valve relief.
2-1.50mm, 1-4.00mm	66mm dia. Recessed head 1.50mm deep. SOHC Mitsubishi "J" eng. (1979-84), "Q" eng. (1980-84)
1-2.0mm, 1-2.5mm, 1-4.0mm	.110" Crown head. 20R eng.
2-5/64, 1-3/16	Flat top with 4 valve reliefs.
2-5/64, 1-3/16	2 Large Valve Reliefs with Fire Slot. For use on either Right or Left cyl. Bank. Iron Top Groove. LF9 Diesel.
2-5/64, 1-3/16	2 Large Valve Reliefs with Fire Slot. For use on either Right or Left cyl. Bank. Iron Top Groove. LT6 Diesel. LT7 with Fire Slot.
1-1.75mm, 1-2.00mm, 1-3.00mm	Swirl Chamber Recess 1.8mm deep. Volkswagon Golf, Passat Diesel. (8/76-7/80)
2-1.50mm, 1-4.00mm	2.181 dia. Recessed head, .100" deep. Courier VB eng.
1-3/32, 1-5/64, 1-3/16	Flat Head w/2 valve reliefs. Trk. Eng. Iron Groove.
1-3/32, 1-5/64, 1-3/16	Flat Head w/2 valve reliefs. Trk. Eng. Iron Groove.
2-5/64, 1-3/16	3.913" dia. Head recess .256" deep.
2-1.5mm, 1-4.0mm	2.46" dia. Head recess .020" deep.
2-5/64, 1-3/16	Flat Head. Shallow Oil Groove.
2-5/64, 1-3/16	Flat Head w/4 valve reliefs.
1-1/16, 1-5/64, 1-5/32	2.290" dia. Recessed head .500" deep. 1978-80 car.
1-1.5mm, 1-2.0mm, 1-4.75mm	Flat Head. VIN W. 2nd design with 1.5mm top ring.
1-1.5mm, 1-2.0mm, 1-4.75mm	Flat Head. VIN W. 2nd design with 1.5mm top ring.
2-5/64, 1-3/16	2.70" dia head recess .107" deep.
1-1/16, 1-5/64, 1-3/16	3.07" dia. Head recess .226" deep. Shallow groove. Low Tension rings.

New CEP#	TC #	Set Qty	Bore (in.)	Bore (mm.)	Comp. Ratio	Comp. Height	Piston Length	Pin Diameter	Head Config.	*Mat'l.	Min. Skirt Clearance	Measure Skirt Clearance at:
224-2151	TC2151	4	3.1496	80.00	8.0:1	1.406	2.86	0.7868	1	-	.0013	.700" up from skirt bottom
224-2154	TC2154	4	2.992	76.00	8.5:1	30mm	2.559	19mm	43	-	.0012	
224-2158	TC2158	6	3.750	95.25	8.2:1	1.632	3.40	0.931	46	-	.0015	.310" up from skirt bottom
224-2159	TC2159	4	3.5866	91.10	8.2:1	1.385	3.06	0.8662	1	-	.0015	.750" up from skirt bottom
224-2178	-	-	3.4250	87.00	8.5:1	1.398	2.835	0.827	47	-	.0008	.700" up from skirt bottom
224-2179	TC2179	6	3.8000	96.50	8.0:1	1.805	2.99	0.9398	3	-	.0015	bottom of skirt
224-2182	-	4	3.3465	85.00	8.5:1	1.260	2.637	21.0mm	-	-	.0004	1.260" Down from top of head
224-2185	TC2185	8	3.9764	101.00	20.1:1	2.119	3.3	1.22	18	-	.0025"	.375" Up from bottom.
224-2187	TC2187	6	3.811	96.80	8.65:1	1.584	3.031	0.9122	48	-	.0015	.750" up from skirt bottom
224-2190	TC2190	8	4.000	101.60	19.7:1	1.945	3.45	1.11	18	-	.0050	1.500" up from skirt bottom
224-2192	TC2192	4	3.4449	87.50	8.5:1	1.570	3.02	0.9009	1	-	.0014	.650" up from skirt bottom
224-2222	TC2222	8	3.736	94.90	9.5:1	1.540	3.19	0.9273	6	-	.0015	pin center line
224-2225	TC2225	6	3.800	96.50	8.5:1	1.808	3.00	0.9398	1	-	.0015	bottom of skirt
224-2226	TC2226	4	3.1496	80.00	8.8:1	1.560	2.75	0.812	49	-	.0026	.250" up from skirt bottom
224-2230	TC2230	4	3.4449	87.50	8.5:1	1.593	3.00	0.9012	50	H	.0023	pin center line
224-2231	TC2231	8	3.7500	95.25	8.5:1	1.638	-	0.9309	-	-	.0010	1.00" up from skirt bottom
224-2234	TC2234	8	4.08	103.63	9.0:1	1.580	3.54	0.931	51	-	-	.750" up from skirt bottom
224-2274	TC2274	4	3.5180	89.40	8.0:1	1.578	2.98	0.9122	52	-	.0015	.580" up from skirt bottom
224-2275	TC2275	4	2.9134	74.00	8.9:1	27.7mm	2.48	17mm	100	-	.0012	1.68" down from top
224-2276	-	-	2.8346	72.00	7.9:1	27.5mm	-	17mm	17	-	0.01mm	bottom of skirt
224-2281	TC2281	4	3.3369	84.78	8.8:1	1.555	-	0.9055	-	-	0.001	2.43" down from top
224-2283	TC2283	4	3.680	93.50	9.0:1	1.500	3.03	0.9122	1	-	.0015	1.126" up from skirt bottom
224-2284	-	-	2.8346	72.00	8.0:1	27.5mm	2.461	17mm	4	-	.0012	bottom of skirt
224-2289	TC2289	4	3.3858	86.00	8.8:1	35mm	2.756	22mm	53	-	.0012	.71" up from skirt bottom
224-2290	-	-	3.7008	94.00	-	47.9mm	-	25.15mm	1	-	0.02mm	80.8mm from top of head
224-2291	TC2291	4	3.622	92.00	9.0:1	1.526	3.63	0.8665	-	-	.0015	1.259" up from skirt bottom
224-2297	-	-	3.031	77.00	-	1.220	2.48	0.787	-	-	-	
224-2300	-	-	3.3465	85.00	-	40.5mm	-	22.0mm	55	-	0.01mm	52.5mm from top of dome
224-2302	-	-	3.3268	84.50	8.5:1	1.165	2.26	0.7874	94	-	.0015	
224-2303	-	-	2.9921	76.00	-	33.50mm	-	19.0mm	4	-	0.02mm	36mm from top of head
224-2304	TC2304	4	2.9921	76.00	8.5:1	1.2795	2.46	0.748	56	-	.0015	
224-2305	TC2305	4	2.9921	76.00	9.4:1	1.262	2.44	0.7485	25	-	-	.500" up from skirt bottom
224-2308	-	-	-	80.00	-	1.425	2.882	0.787	1	-	-	.687" up from skirt bottom
224-2309	-	-	-	77.00	-	1.142	2.402	0.787	-	-	-	.625" up from skirt bottom
224-2310	TC2310	4	3.307	84.00	8.7:1	33.4mm	2.771	20mm	53	-	.0008	.787" up from skirt bottom
224-2311	TC2311	4	3.189	81.00	9.0:1	1.193	2.37	0.709	107	-	.0017	.500" up from skirt bottom
224-2312	TC2312	6	3.2677	83.00	8.8:1	1.280	2.77	0.8665	57	-	.0015	bottom of pin boss
224-2313	-	-	3.0512	77.50	-	31.0mm	-	18.0mm	33	-	0.01mm	51mm from top of head
224-2314	-	-	3.0512	77.50	9.1:1	1.201	2.39	0.7088	58	-	.004	bottom of skirt
224-2315	TC2315	4	3.622	92.00	9.3:1	1.355	2.49	0.8665	60	-	.0015	.500" up from skirt bottom
224-2321	TC2321	4	4.000	101.60	-	1.625	3.27	0.9273	13	H	.0020	1.00" up from skirt bottom
224-2322	TC2322	6	4.000	101.60	9.2:1	1.581	3.29	0.931	-	-	.0015	pin center line
-	TC2322B	4	4.000	101.60	9.2:1	1.581	3.29	0.931	46	-	.0015	pin center line
224-2330	TC2330	4	3.327	84.50	8.5:1	29.5mm	2.559	20mm	47	-	.0015	.600" up from skirt bottom
224-2331	TC2331	6	3.425	87.00	varies	1.250	2.62	0.8259	81	-	.0015	.562" up from skirt bottom
224-2332	TC2332	4	-	96.00	-	-	-	-	-	-	-	.750" up from skirt bottom
224-2334	TC2334	4	2.972	75.50	9.4:1	29mm	2.283	18mm	93	-	.0008	.500" up from skirt bottom
224-2335	TC2335	4	3.425	87.00	8.4:1	1.455	3.15	0.8662	-	-	.001	2.35" from top of head
224-2336	-	-	-	76.50	-	1.643	2.822	24mm	-	-	-	See O.E. repair manual
224-2338	-	-	3.310	-	-	1.752	2.937	0.984	18	-	.0010	.312" up from skirt bottom
224-2347	TC2347	4	3.4449	87.50	9.0:1	1.573	2.78	0.9009	61	-	.0013	.400" up from skirt bottom
224-2348	TC2348	4	3.4449	87.50	varies	1.573	2.78	0.9009	-	-	.0013	.400" up from skirt bottom
224-2349	TC2349	4	3.4449	87.50	8.0:1	1.591	2.76	0.9009	61	H	.0023	.720" Up from bottom
224-2350	TC2350	4	3.2260	81.94	9.0:1	1.470	2.65	0.8121	62	-	.0020	.475" Up from bottom
224-2351	TC2351	4	3.2260	81.94	9.0:1	1.540	2.92	0.8121	1	-	.0020	.60" Up from bottom
224-2353	TC2353	6	3.504	89.00	9.3:1	1.535	2.64	0.9122	1	H	.0015	.38" Up from bottom
224-2357	TC2357	6	3.504	89.00	8.5:1	1.599	3.05	0.9055	1	-	.0012	.700" Up from bottom
224-2358	TC2358	4	3.504	89.00	9.0:1	1.578	2.76	0.8002	16	-	.0012	top of skirt slipper
224-2359	TC2359	8	3.464	88.00	8.5:1	1.630	3.33	0.8657	3	-	.0015	top of skirt slipper
224-2364	-	-	3.012	76.50	23.5:1	1.642	2.822	0.945	18	-	0.0012	1.00" up from skirt bottom
224-2366	-	-	3.622	92.00	8.5:1	1.815	2.975	0.945	25	-	0.0012	1.00" up from skirt bottom
224-2367	-	-	3.622	92.00	7.5:1	1.835	2.815	0.945	25	-	0.0012	1.00" up from skirt bottom

\*H = Hypereutectic

<u>Rings</u>	<u>Notes</u>
1-1.2mm, 1-1.5mm, 1-4.0mm	Flat Head. Use early design ring pack. Ford-Courier.
1-1.2mm, 1-2.00mm, 1-4.00mm	Small round Recess in head . A15 eng.
2-5/64, 1-3/16	Recessed head .185" deep.
2-2.00mm, 1-4.00mm	.200" recessed head. Shallow Oil Groove Mitsu.-F & W to 4/83. G54B eng.
2-1.50mm, 1-4.00mm	Recessed head w/4 valve reliefs.
2-5/64, 1-3/16	3.05" dia. Head recess .245" deep. Turbo.
2-1.50mm, 1-4.00mm	Flat Head w/4 small recesses. (1980-81) Z20E, Z20S eng. From 1/80. (1980-89) Car & trk. (non-USA) Z20 eng., from 7/80. Use ring set# 41289.
1-3.00mm, 1-2.00mm, 1-4.00mm	Ricardo recess .158 in. deep 6.2L GM Diesel. Ni-Resist Ring Carrier.
2-2.00mm, 1-4.00mm	2.170" dia head recess .071" deep w/2 valve reliefs.
2-5/64, 1-7/64	Diesel Trk. Swirl Chamber, (6.6cc cup). B Series. Not Destroyed. Iron Top Groove
2-1.50mm, 1-4.0mm	Flat Top. Omni & Horizon with E62 Engine. 1983-86 C.R. = 9.0:1. Shallow Groove
2-5/64, 1-3/16	Flat head w/4 valve reliefs. H.O. engs. LU7 eng. TBI.
2-5/64, 1-3/16	Flat Top. Buick-LK9 eng. 1985 high deck engs, used in "C" cars only.
2-1.50mm, 1-4.0mm	Dome head .310" high. May be used to replace dished head pistons. Courier 1800cc eng.
2-1.50mm, 1-4.00mm	2.20" dia. Head recess .190" deep. Turbo. Shallow Groove. Not Destroyed
2-5/64, 1-3/16	.170" Recessed head. Press Fit Pin.
2-2.00mm, 1-5.00mm	3.60" dia head recess .190" deep w/ 4 valve reliefs.
2-2.00mm, 1-4.75mm	Flat head w/2 Valve reliefs Ranger.
2-1.25mm, 1-2.80mm	Recessed Head w/2 valve reliefs.
2-1.50mm, 1-4.00mm	63.00mm dia head recess .50mm deep. EJ1 eng.
1-1.50mm, 1-1.75mm, 1-4.00mm	2.710" dia. Head recess .125" deep. Thin rings and shallow groove for low tension oil ring. Opel Brazilian eng.
2-5/64, 1-3/16	Flat Head. HSC Eng.
2-1.50mm, 1-4.00mm	Recessed head .5mm deep.
2-1.50mm, 1-4.00mm	Recessed head.
1-2.00mm, 1-2.50mm, 1-4.00mm	Flat head w/0.3mm step rim. 2FE eng.
1-2.00mm, 1-2.5mm, 1-4.0mm	Crown .25" high with 2.30" dia. Ead recess .20" deep. 22R eng.
2-1.50mm, 1-4.00mm	Dish head, 1.2mm deep. Appl: 1979-80 1415cc 4 cyl. Mazda.
2-1.50mm, 1-4.00mm	70.00mm dia dome head 5.30mm high. Non-USA car: 3T eng. To 8/81. USA car-8/79 to 8/82 ETC eng.
2-1.50mm, 1-4.00mm	Recessed head .06" deep w/4 valve reliefs. Use early style rings. CA20E, S only.
2-1.50mm, 1-4.00mm	70.00mm dia head recess, 10.00mm deep. Non usa car-E15 from 8/81-7/82. USA car-E15 eng.-310-Sentra from 8/81-7/82
2-1.50mm, 1-4.00mm	.420" recessed head; exc. Turbo. E15S, E15T.
2-1.50mm, 1-4.00mm	2.35" dia. Head recess .360" deep. E16, E16i & E16S engines. Sentra 82-88, Pulsar 84-88. 1987-88 EFI.
1-1.50mm, 1-2.00mm, 1-4.00mm	Flat head. 1982-86 2000cc Mazda, B2000 & 626.
1-1.50mm, 1-2.00mm, 1-4.00mm	Recessed head with 1 valve relief. 1983-85 Mazda 1500cc (GLC 1490).
2-1.50mm, 1-4.00mm	Recessed head 4.2mm deep. 2SELG eng.
2-1.50mm, 1-2.80mm	Heart Shaped recess .129" deep. 4ALC eng. Chevy-Nova. Toyota-OHC
2-1.50mm, 1-4.00mm	Dome .143" high 2.37" dia. W/2 valve reliefs. Full Floating pin. 5MGE eng.
2-1.50mm, 1-2.80mm	Flat head w/2 valve reliefs. 1AC eng.
2-1.50mm, 1-2.80mm	Recessed head .11" deep w/2 valve reliefs. 3AC eng.
2-1.50mm, 1-4.00mm	2.50" dia. Head recess .070" deep w/ 2 valve reliefs. 22R eng. Replacement Style Piston
2-5/64, 1-3/16	3.20" dia. Head recess .13" deep, (14cc cup). Mercruiser Marine reverse rotation engine. Not Destroyed. T6 Heat Treatment
2-5/64, 1-3/16	Rectangular head recess .096" deep. VIN U.
2-5/64, 1-3/16	Rectangular head recess .096" deep. VIN U.
2-1.50mm, 1-4.00mm	Recessed head 1.7mm deep, w/4 valve reliefs. CA20E eng., CA20S eng.
2-1.5mm, 1-2.8mm	Flat head w/2 valve reliefs. VG30E & VG30I eng. SOHC non-turbo. Late style rings. Use with part number 41578. 200SX, 300ZX, Maxima, Pathfinder, Pickup. Comes with lockrings.
	11/82-5/85, 2389cc Datsun 720 Pickup (Z24) eng.
2-1.50mm, 1-4.00mm	Recessed head .7mm deep w/4 valve reliefs. Mitsubishi& Chrysler-G15B, G4AJ eng., Chrysler-Q eng., Hyndai-G4AJ eng.
2-1.50mm, 1-4.00mm	1984-85 1949cc (G200Z eng.), Isuzu troper II. 1983-85 GMC "S" Series truck, (1.9L), 119 CID eng. SOHC. 1982 style ring pack (use w/ ring set# 41453)
1-1.75mm, 1-2.00mm, 1-3.00mm	Ricardo Bowl head.
1-2.50mm, 1-2.00mm, 1-4.50mm	-
2-1.5mm, 1-4.0mm	2.64" dia. Head recess .161" deep. Non-turbo, non-EFI.
2-1.5mm, 1-4.0mm	Trench valve relief. Non-turbo. All Fuel Injected. Carb. Omni and Horizon.
2-1.5mm, 1-4.0mm	2.60" dia. Head recess .190" deep w/2 valve reliefs. Lock-rings included. Not destroyed. Shallow Groove. Turbo.
2-1.5mm, 1-4.0mm	Flat head w/2 valve reliefs. Not EFI. Not Destroyed. Shallow Groove.
2-1.5mm, 1-4.0mm	Contoured Head. EFI. Not Destroyed. Shallow Groove.
2-1.5mm, 1-4.0mm	Flat head. Not destroyed after Jan. 1990. Pass. Car & trks. Not special HO models. Shallow Groove.
1-1.5mm, 1-2.0mm, 1-4.75mm	Flat head. May replace 224--2130 but will not be Destroyed. Isuzu-Trooper & pickup. VIN R. Shallow Groove.
2-1.5mm, 1-4.75mm	2.37" dia. Head recess .155" deep. Small pin. Shallow Groove.
2-2.0mm, 1-4.00mm	2.10" dia. Head recess .142" deep. Available in .003" & .005" oversizes. VIN 8. Shallow Groove.
1-1.75mm, 1-2.00mm, 1-3.00mm	Ricardo Bowl Head. Volkswagon Golf, akt., Aufladung, Fahrzeug (8/89-7/92); Jetta (8/89-9/91); USA Rabbit, Golf, Jetta, Passat, Santana, 245/247/251/253/255 (8/81-10/91); Passat (8/88-7/93); Aufladung, Fahrzeug: LT 28/31/35/40/45/50/55 (12/82-8/92).
1-1.75mm, 1-2.00mm, 1-4.00mm	Recessed Head 2.1mm deep. Vergaser, Fahzeug: 242, 244, 245 (1974-1978); Einspritzung, Fahzeug: 242, 244, 245 (USA) (1979-80.)
1-1.75mm, 1-2.00mm, 1-4.00mm	Recessed Head 2.3mm deep. Einspritzung, Aufladung; Fahrzeug: 240, 244, 245; Einspritzung Aufladung, Fahrzeug: 244 (USA)

New CEP#	TC #	Set Qty	Bore (in.)	Bore (mm.)	Comp. Ratio	Comp. Height	Piston Length	Pin Diameter	Head Config.	*Mat'l.	Min. Skirt Clearance	Measure Skirt Clearance at:
224-2368	-	-	3.012	76.50	-	1.647	2.824	0.945	18	-	0.0012	1.00" up from skirt bottom
224-2374	TC2374	4	2.9724	75.50	9.4:1	1.146	2.31	0.7088	13	-	.0012	3.25" below pin centerline
224-2375	TC2375	4	3.5866	91.10	-	35.20mm	-	22mm	3	-	0.02mm	67.2mm from top of head
224-2377	-	-	3.268	83.00	-	30mm	2.559	19.99mm	-	-	.0008	.600" up from skirt bottom
224-2378	-	-	3.346	85.00	-	32mm	2.638	21.01mm	-	-	.0005	.500" up from skirt bottom
224-2379	-	-	3.3858	86.00	-	38mm	3.079	21.01mm	-	-	.0008	.625" up from skirt bottom
224-2380	-	-	3.268	83.00	-	48.01mm	3.543	26.01mm	-	-	.0030	.562" up from skirt bottom
224-2382	-	-	3.4645	88.00	-	47.50mm	3.543	27mm	-	-	0.0062	.600" up from skirt bottom
224-2384	-	-	3.14956	80.00	varies	30mm	2.618	20mm	47	-	.0015	top of skirt slipper
224-2387	-	-	3.6220	92.00	-	1.937	-	27mm	105	-	0.05mm	pin center line
224-2500	-	-	3.3858	86.00	varies	35mm	2.637	22mm	63	-	.0008	.500" up from skirt bottom
224-2511	TC2511	8	4.000	101.60	varies	1.540	3.2	0.9273	6	H	.0015	top of skirt slipper
224-2517	TC2517	8	4.000	101.60	8.4:1	1.540	3.19	0.9273	25	-	.0015	pin center line
224-2552	TC2552	6	3.800	96.50	9.0:1	1.805	2.91	0.9398	3	-	.0015	bottom of skirt
224-2553	TC2553	8	4.082	103.70	8.2:1	2.003	3.72	0.9997	1	-	.0015	.880" up from skirt bottom
224-2554	TC2554	4	3.226	81.94	9.0:1	1.286	2.48	0.8121	65	-	.0020	Down 2.03" from top of head
224-2555	TC2555	6	3.811	96.80	9.0:1	1.614	2.71	0.9122	48	-	.0015	.450" up from skirt bottom
224-2556	TC2556	4	3.226	81.94	9.0:1	1.367	2.55	0.8121	49	H	.0015	.400" up from skirt bottom
224-2557	TC2557	4	2.7953	71.00	9.0:1	1.120	2.35	0.787	66	-	.0013	.500" up from skirt bottom
224-2558	TC2558	8	3.7360	94.90	varies	1.540	3.19	0.9275	91	-	0.001	1.80" from top of head
224-2559	TC2559	4	3.054	89.00	9.0:1	1.330	2.15	0.8002	3	-	.0015	.200" Up from bottom of head
224-2561	TC2561	4	3.3858	86.00	7.8:1	1.420	2.79	0.8657	67	H	.0020	.700" Up from bottom
224-2563	TC2563	4	3.3862	86.00	8.6:1	1.417	2.795	0.8653	67	-	.0014	2.08" from top of head
224-2565	TC2565	8	4.040	102.60	10.2:1	1.824	3.51	0.9842	68	-	.0015	.875" up from skirt bottom
224-2566	TC2566	4	3.0709	78.00	-	1.230	2.46	0.7865	66	-	.0021	1.98" from top of head
224-2567	TC2567	4	4.000	101.60	varies	1.566	2.85	0.9273	3	H	.0015	.500" up from skirt bottom
224-2581	TC2581	6	4.000	102.00	8.5:1	1.767	3.367	0.9751	13	H	0.001	2.47" from top of head
224-2587	TC2587	8	4.000	101.60	8.2:1	1.608	3.35	0.9122	69	-	.0015	1.10" Up from bottom
224-2625	TC2625020	4	3.875	98.40	4.2:1	1.906	-	0.9997	1	-	.0020	bottom of skirt
224-2692	-	-	3.0118	76.50	-	1.647	2.825	0.945	-	-	.0012	above skirt slipper
224-2694	TC2694	8	4.000	101.60	7.9:1	1.540	3.19	0.9273	91	-	.0015	.900" up from skirt bottom
-	TC2694A	6	4.000	101.60	7.9:1	1.540	3.19	0.9273	91	-	.0015	.900" up from skirt bottom
224-2695	-	-	3.3369	84.78	8.0:1	1.555	2.82	0.9055	56	-	0.001	2.43" from top of head
224-2696	-	-	4.000	101.60	-	1.540	3.07	0.9275	15	-	0.001	2.23" from top of head
224-2699	TC2699	6	3.661	93.00	9.0:1	1.527	2.87	0.9450	61	-	.0011	.70" Up from bottom
224-2701	-	-	3.5866	91.10	-	-	-	-	-	-	.0010	.550" up from skirt bottom
224-2704	-	-	4.000	101.60	7.8:1	1.767	3.37	0.9751	-	H	.0012	2.47" from top of head
224-2705	-	-	3.7795	96.00	-	1.575	2.85	0.9122	8	H	.0014	2.38" from top of head
224-2707	TC2707	8	4.250	108.00	varies	1.627	3.375	0.9898	71	H	.0020	1.00" up from skirt bottom
224-2712	TC2712	4	3.3465	85.00	8.5:1	1.360	2.83	0.8267	72	-	-	.688" Up from bottom
224-2714	-	-	3.030	77.00	-	1.126	2.323	0.708	-	-	.0015	top of skirt slipper
224-2715	-	-	3.030	77.00	-	1.126	2.323	0.708	-	-	.0015	top of skirt slipper
224-2716	-	-	3.190	81.00	-	1.307	2.46	20mm	-	-	.0013	.500" up from skirt bottom
224-2719	TC2719	3	2.913	74.00	varies	1.114	2.177	17mm	73	-	.0012	3.25" below centerline
224-2735	-	-	4.000	101.60	7.6:1	1.640	3.28	0.9751	13	-	.0025	pin center line
224-2736	-	-	3.386	86.00	8.6:1	36mm	2.795	22mm	-	-	.0015	top of skirt slipper
224-2740	TC2740	8	3.9375	100.00	varies	2.160	4.00	0.9898	-	-	.0020	1.00" up from skirt bottom
224-2741	TC2741	8	4.250	108.00	varies	2.160	3.91	0.9898	75	-	.0025	1.06" Up from bottom
224-2742	TC2742	8	3.1875	81.00	7.0:1	1.763	3.17	0.7503	22	-	.0015	bottom of skirt
224-2744	-	-	4.250	108.00	8.2:1	1.634	3.38	0.9897	59	-	.0015	pin center line
224-2745	TC2745	8	4.000	101.60	8.5:1	1.540	3.19	0.9273	76	-	.0015	.90" Up from bottom
-	TC2745A	6	4.000	101.60	8.5:1	1.540	3.19	0.9273	76	-	.0015	.90" Up from bottom
224-2746	TC2746	4	3.2260	81.94	9.0:1	1.540	2.72	0.8121	49	-	.0020	pin center line
224-2747	TC2747	8	3.1875	81.00	7.0:1	1.763	-	0.7503	22	-	.0015	.250" up from skirt bottom
224-2751	TC2751	6	3.250	82.60	6.9:1	1.978	3.66	0.8593	1	-	.0015	bottom of skirt
224-2753	-	-	3.1875	81.00	varies	30.5mm	2.539	20mm	78	-	.0008	top of skirt slipper
224-2754	TC2754	4	3.385	86.00	8.8:1	1.171	2.12	0.8271	3	-	.0015	pin center line
224-2755	TC2755	6	3.700	94.00	9.0:1	1.310	2.43	0.9054	3	-	.0015	.750" up from skirt bottom
224-2756	TC2756	4	3.125	79.40	varies	2.167	3.73	0.8120	1	-	.0020	.375" Up from bottom of skirt
224-2757	TC2757	6	3.504	89.00	8.8:1	1.450	2.28	0.9054	25	-	.0016	.20" Up from bottom
224-2758	TC2758	6	3.504	89.00	8.8:1	1.450	2.28	0.9055	3	-	.0015	.20" Up from bottom
224-2759	TC2759	6	3.800	96.50	8.5:1	1.366	2.56	0.9054	3	-	.0015	.50" Up from bottom

<u>Rings</u>	<u>Notes</u>
1-1.75mm, 1-2.00mm, 1-3.00mm	Ricardo Bowl Head.
2-1.50mm, 1-4.00mm	Recessed head .15" deep (For 1987-90 engs.)
2-1.50mm, 1-4.00mm	2.670" dia. Head recess .200" deep. (1984-85 u.s.a car FWD from 5/83, 1984-87 LD trk. FWD from 5/83; SOHC TURBO 1984-89).
2-1.50mm, 1-2.80mm	Flat head w/4 valve reliefs
2-1.50mm, 1-4.00mm	Recessed head w/4 valve reliefs in recess
1-1.50mm, 1-2.00mm, 1-4.00mm	Recessed head
1-2.50mm, 1-2.00mm, 1-4.50mm	Ricardo Bowl recess w/2 valve reliefs
1-2.50mm, 1-2.00mm, 1-4.50mm	Ricardo Bowl recess w/2 valve reliefs
2-1.50mm, 1-4.00mm	Recessed head 1.2mm deep w/4 valve reliefs. ET2 & A18A1 12V engs.
2-2.00mm, 1-4.00mm	Recessed head 1.50mm deep. Diesel 2L Eng.
1-1.20mm, 1-1.50mm	Flat top w/4 valve reliefs. Celica GTS DOHC, 3SGELC 16 V eng.
2-5/64, 1-3/16	Flat head w/4 valve reliefs. Not intended for Racing. Destroyed .020" . Same as 224-2770 except Hypereutectic.
2-5/64, 1-3/16	3.30" dia. Head recess .270" deep. (32cc). For use with 305 heads.
2-5/64, 1-3/16	2.49" dia. Head recess .160" deep.
2-5/64, 1-3/16	Flat Head.
2-1.50mm, 1-3.0mm	Wedge type head recess, 2 valve reliefs. Escort, CFI. 1996 SEFI, J. Shallow Groove
2-1.50mm, 1-4.0mm	2.170" dia. Head recess .145" deep w/2 valve reliefs. Non-supercharged. Shallow Groove.
2-1.50mm, 1-3.0mm	Contoured Head. EFI. Not Destroyed. Shallow Groove.
1-1.20mm, 1-1.50mm, 1-3.00mm	Crowned head head recess 2.40" dia., .040" deep w/3 valve reliefs (5.0cc), Festiva.
2-5/64, 1-3/16	3.130" dia. Head recess .062" deep. VIN "H".
2-1.50mm, 1-3.00mm	2.675" dia. Head recess .295" deep, (21cc). EFI, OHV, VIN 1. Small Pin. Olds-J Body. Shallow Groove.
2-1.50mm, 1-4.00mm	2.57" dia. Head recess .355" deep w/4 valve reliefs. Ford-Probe Turbo. Mazda-Turbo, F2 eng.
2-1.50mm, 1-4.00mm	2.610" dia head recess .265" deep. Mazda F2 eng.
2-5/64, 1-3/16	Flat Top w/ 4 valve reliefs. Piston may be used in either Left or Right cyl bank.
2-1.50mm, 1-4.00mm	2.580" dia. Head recess .020" deep. Mazda 8 valve eng. Ford (1987-89). Mazda (1986-94)
1-1/16, 1-5/64, 1-3/16	3.10" dia. head recess .140" deep. Replace in full sets only. Not intended for racing. Destroyed .020". Shallow Groove.
2-5/64, 1-3/16	D shaped recessed head .300" deep. 1983-95 LD trk. incl. Fuel injection. 1977-82 LD Trk. will replace circular cup piston in complete sets. 1969-76 LD Trk. from change L16 exc. F100.
2-1.50mm, 1-4.00mm	2.50" dia. Head recess .030" deep with four valve reliefs.
2-1/8, 1-5/32	Model A. Maximum oversize .060".
1-1.75mm, 1-2.00mm, 1-3.00mm	Ricardo Bowl head.
2-5/64, 1-3/16	3.16" dia. Head recess .08" deep 4 valve reliefs, (13cc). Use 1986 & earlier rings. Chevy-Exc. Special High Performance & 1982 Corvette. Oldsmobile-1992-94 Bravada, Olds, Pontiac, Buick-VIN L.
2-5/64, 1-3/16	Use w/ ring set # 40664CP, 50664CP
1-1.50mm, 1-1.75mm, 1-4.00mm	2.710" dia head recess, .220" deep. Brazilian eng.
2-5/64, 1-3/16	3.265" dia. Head recess, .067" deep. W/Shallow oil ring groove VIN Code "8".
1-1/16, 1-1.75mm, 1-3.5mm	2.42" dia. head recess .295" deep. Trucks. Passenger cars 1988-89. Shallow Groove
2-1.50mm, 4.00mm	G545B Turbo eng.
2-5/64, 1-3/16	3.210" dia. Recessed head .300" deep. From Change L16.
2-1.50mm, 1-4.00mm	Flat Head w/2 valve reliefs. Eng. W/dual spark plug. Up to 1994.
2-5/64, 1-3/16	2.00" dia. Head recess .085" deep w/2 valve reliefs. Trk. Eng. Not intended for racing. Destroyed .020".
2-1.50mm, 1-4.00mm	2.50" dia. Head recess .05" deep w/3 valve reliefs. Late Style ring grooves. G63B, 4G63 SOHC eng.
2-1.22mm, 1-2.82mm	Recessed head. Turbo Spectrum. 4XC1T eng.
1-1.50mm, 1-2.80mm	Non-turbo. 4XC1 eng.
1-1.50mm, 1-1.75mm, 1-3.00mm	Offset recessed head. VolksWagon-RD, HT, UM, JN, GX, PF, RV, 2H. Audi-MG, JN.
1-1.20mm, 1-1.50mm	Recessed head 1.2mm deep w/2 valve reliefs. Geo 1298cc-G13BA eng., Geo 993cc-G10 eng., Suzuki 1324cc-G13A & G13BA eng.
2-5/64, 1-3/16	Recessed head .14" deep. -Optional Low Comp. Piston-(for late 1969-76 After change L16).
2-1.50mm, 1-4.00mm	Mazda-F2 8V eng. Kia-FE eng. Recessed head 5.4mm deep, w/3 valve reliefs. The larger Relief is the Intake side.
1-3/32, 2-5/64, 1-3/16	3/32" step head propane pop-up piston w/ one valve relief. 1985-90 gas trk. Exc. H5D, not destroyed. Use Early style rings. Iron Top Groove.
1-3/32, 2-5/64, 1-3/16	Off Center Combustion recess w/ one valve relief. Trk. Eng. Not destroyed. Iron Top Groove.
2-3/32, 2-3/16	Dome head.
2-5/64, 1-3/16	Recessed head .08" deep w/1 valve relief (For 1984-90 engs.). Iron Top Groove.
2-5/64, 1-3/16	3.250" dia. Head recess .130" deep w/2 trough valve reliefs. Use w/ring set# 40564CP, 50564CP
2-5/64, 1-3/16	3.250" dia. Head recess .130" deep w/2 trough valve reliefs. Shallow Groove.
2-1.50mm, 1-4.00mm	Contoured Head. EFI. Not Destroyed. Shallow Groove.
2-3/32, 2-3/16	Dome head.
2-3/32, 2-5/32	Plymouth Flat Head
2-1.50mm, 1-2.80mm	Recessed head 1.2mm deep, with 4 valve reliefs. Chevy Nova 1587cc, 4AGELC, 16V. Toyota Corolla FX, FX16, FX 16 GTS, MR2.
2-1.50mm, 1-3.00mm	2.78" dia. Head recess .142" deep. Non-turbo, J Car, VIN K. Shallow Groove.
2-1.50mm, 1-3.00mm	2.83" dia. Head recess .123" deep.
2-3/32, 1-3/16	L and F, Flat head. 3 ring piston.
2-1.50mm, 1-4.00mm	2.88" dia. Head recess .247" deep. For Aluminum Head applications. Use early style rings.
2-1.50mm, 1-4.00mm	2.95" dia head recess .106" deep. Iron Head. TBI. Chevy-APV only. Olds.-Silhouette, VIN D. Isuzu-Rodeo pickup, VIN Z.
2-1.50mm, 1-3.00mm	3.10" dia. Head recess .25" deep. Destroyed .020". Shallow Groove. Buick-Riviera, SFI, VIN C. Chevy-Lumina. Olds.-VIN C. Holden-Australian Export.

New CEP#	TC #	Set Qty	Bore (in.)	Bore (mm.)	Comp. Ratio	Comp. Height	Piston Length	Pin Diameter	Head Config.	*Mat'l.	Min. Skirt Clearance	Measure Skirt Clearance at:
224-2761	TC2761	6	3.800	96.52	8.5:1	1.377	-	0.9054	-	H	.001	1.71" from top of head
224-2762	-	-	3.7795	96.00	-	1.577	2.83	0.9122	-	H	.0015	2.25" from top of head
224-2770	TC2770	8	4.000	101.60	8.8:1	1.540	3.20	0.9273	6	-	.0015	15/16" up from bottom
224-2773	-	-	3.3858	86.00	8.8:1	1.162	-	0.8267	-	H	.001	1.83" from top of head
224-2774	TC2774	4	3.5039	89.00	9.0:1	1.170	2.00	0.8002	3	-	.0015	bottom of skirt
224-2775	TC2775	8	4.250	108.00	8.75:1	1.627	2.89	0.9898	71	H	.0025	.55" Up from bottom
224-2777	-	-	4.3620	110.70	8.1:1	2.140	3.59	1.0402	-	H	.001	3.00" from top of head
224-2779	-	-	3.5866	91.10	-	1.395	3.05	0.8662	1	H	.001	2.30" from top of head
224-2781	-	-	3.5866	91.10	-	1.395	3.05	0.8662	-	H	.001	2.30" from top of head
224-2783	TC2783	4	3.4449	87.50	8.9:1	1.350	2.125	0.9009	-	-	.0013	bottom of skirt
224-2788	TC2788	8	4.250	108.00	8.6:1	1.645	3.210	0.990	-	F	.003	1.26" Up from bottom
224-2792	TC2792	4	3.4449	87.50	varies	1.350	2.215	0.9009	-	-	-	.50" Up from bottom
224-2795030	TC2795030	8	4.000	101.60	-	1.425	2.78	0.928	-	H	.0010	bottom of pin boss
224-2797	TC2797	8	3.622	92.00	9.5:1	1.250	2.31	0.8662	1	-	-	1.7" down from top
224-2798	-	-	3.6220	92.00	-	1.627	2.72	0.8661	3	-	.0015	2.31" down from top
224-2800	-	-	3.6220	92.00	-	1.627	2.72	-	-	-	.0015	2.31" down from top
224-2801	-	-	4.000	101.60	-	1.542	2.72	0.9279	-	H	.0015	1.92" from top of head
224-2802	TC2802	6	3.5039	89.00	8.5:1	1.598	3.05	0.9055	-	-	.001	2.36" down from top
224-2803	TC2803	6	3.504	89.00	8.9:1	1.608	2.48	0.9054	25	-	.0015	.20" Up from bottom
224-2806	-	-	3.8110	96.80	-	1.607	2.607	0.9122	35	H	.0015	1.75" from top of head
224-2808	-	-	4.000	101.60	-	1.784	-	0.9122	-	H	.0015	2.08" from top of head
224-2810	TC2810	8	4.000	101.60	varies	1.540	2.41	0.9273	11	H	.0015	.20" Up from bottom
224-2811	TC2811	4	3.385	86.00	9.2:1	1.171	2.12	0.8266	79	-	.0015	.260" Up from bottom
224-2812	TC2812	6	3.9535	100.40	9.0:1	1.450	-	0.945	-	H	-	.50" Up from bottom
224-2813	TC2813	8	4.000	101.60	9.0:1	1.600	2.85	0.9122	69	H	.0015	.60" up from skirt bottom
224-2814	TC2814	6	3.777	96.00	varies	1.369	2.22	0.9009	80	-	.0015	.20" Up from bottom
224-2815	TC2815	6	3.661	93.00	8.9:1	1.260	2.12	0.9009	80	-	.0015	.19" Up from bottom
-	TC2816	6	3.4449	87.50	varies	1.328	2.47	0.8271	-	-	.0012	.51" Up from bottom
224-2817	TC2817	4	3.5827	91.00	8.8:1	1.368	2.55	0.8665	-	-	.0020	.53" Up from bottom
224-2831	-	-	3.312	84.10	varies	1.980	3.45	0.8593	1	-	.0020	.250" up from skirt bottom
224-2840	TC2840	6	3.562	90.50	7.7:1	2.060	3.5	0.865	1	-	.0015	.375" up from skirt bottom
224-2854	-	-	3.750	95.30	7.8:1	2.029	3.72	0.9273	1	-	.0015	.320" up from skirt bottom
224-2855	TC2855	6	3.437	87.30	6.9:1	1.978	-	0.8593	1	-	.0020	bottom of skirt
224-2877	TC2877	8	4.094	104.00	9.6:1	1.747	3.78	0.9898	106	-	.0015	1.20" up from skirt bottom
224-2880	TC2880	8	4.3600	110.70	8.9:1	1.752	3.248	1.0402	35	H	.001	-
224-2881	TC2881	4	3.180	81.00	-	1.203	2.400	0.7082	-	-	.0025	top of skirt slipper
224-2882	-	8	3.551	90.20	9.0:1	1.210	-	0.866	-	H	.0013	.567" Up from bottom
224-2883	-	-	3.4449	87.50	-	1.239	2.519	0.8268	-	-	0.0011	.500" up from skirt bottom
224-2884	TC2884	6	4.000	101.60	-	1.559	2.425	0.927	-	H	0.0014	.500" up from skirt bottom
-	TC2885	6	3.779	96.00	-	1.507	2.43	0.9449	-	-	0.0014	.375" up from skirt bottom
224-2887	TC2887	4	3.622	92.00	9.5:1	1.240	2.38	0.8665	69	H	.0015	bottom of pin boss
224-2888	-	-	3.800	96.50	varies	1.446	2.62	0.9054	3	-	.0015	bottom of pin boss
224-2889	TC2889020	4	3.228	82.00	9.3:1	1.165	2.07	0.768	17	H	.0015	bottom of pin boss
224-2890	TC2890	4	3.228	82.00	9.5:1	1.165	2.07	0.768	84	H	.0015	bottom of pin boss
224-2891	TC2891	8	4.360	110.70	varies	1.760	3.22	1.04	35	-	.0020	bottom of pin boss
224-2892	-	-	2.9724	75.50	varies	1.133	2.28	0.709	60	-	.0015	bottom of pin boss
224-2893	TC2893	4	3.1732	80.60	9.0:1	1.320	2.67	0.7485	64	-	.0015	bottom of pin boss
224-2894	TC2894	4	2.9528	75.00	varies	1.103	2.28	0.748	82	-	.0010	bottom of pin boss
224-2895	TC2895	3	2.9134	74.00	varies	1.120	2.18	0.6695	83	-	.0013	bottom of pin boss
224-2896	TC2896	6	3.6220	92.00	varies	1.457	2.28	0.9054	17	-	-	-
224-2897	TC2897	8	4.055	103.00	varies	2.119	3.629	1.22	18	-	.004	0.63" from bottom
224-2898	TC2898	4	3.3465	85.00	8.8:1	1.324	2.55	0.8665	84	-	.0015	bottom of pin boss
224-2899	-	-	2.953	75.00	9.6:1	1.195	2.37	0.748	-	-	.0010	bottom of pin boss
224-2900	TC2900	4	3.517	89.30	8.5:1	39mm	3.16	23mm	3	-	.0016	bottom of pin boss
224-2901	TC2901	6	3.625	92.00	8.3:1	1.858	3.42	0.9122	1	-	.0015	.312" up from skirt bottom
224-2902	TC2902	4	3.646	92.60	varies	36.5mm	3.09	23mm	73	-	.0008	bottom of pin boss
224-2903	TC2903	8	3.625	92.00	7.8:1	1.760	3.39	0.9122	1	-	.0015	.531" up from skirt bottom
224-2904	TC2904	8	3.750	95.30	8.6:1	1.760	3.35	0.9122	1	-	.0015	.550" Up from bottom
224-2905	TC2905	4	3.4055	86.50	varies	1.370	2.83	0.8267	85	-	-	-
-	TC2906	6	3.586	91.10	8.85:1	1.247	2.58	0.8665	87	-	.0015	bottom of pin boss
224-2907	TC2907	8	4.000	101.60	varies	1.605	3.24	0.9842	46	-	.0015	bottom of pin boss
224-2908	TC2908	8	4.110	104.40	varies	1.950	3.46	1.11	88	-	.0055	1.00" up from skirt bottom
224-2909	TC2909	4	3.4055	86.50	varies	1.360	-	0.8665	89	-	-	-
224-2911	TC2911	-	3.110	79.00	-	1.102	-	0.7087	-	-	0.0009	.312" up from skirt bottom

\*H = Hypereutectic

<u>Rings</u>	<u>Notes</u>
2-1.50mm, 1-3.00mm	3.050" dia. Head recess .260" deep. VIN C & L. Also 1988-91 Holden 3791cc.
2-2.00mm, 1-4.76mm	Recessed head w/offset D shaped .095" deep.
2-5/64, 1-3/16	Flat Head w/ 4 Valve reliefs, 5.9cc. Truck & Pass. Same as 224--2511 except cast aluminum.
2-1.50mm, 1-3.00mm	2.785" dia. Head recess .130" deep. VIN K.
2-1.50mm, 1-3.00mm	2.94" dia. Head recess .215" deep. Chevy-VIN G 1990-91, 92-94 VIN 4 TBI, EFI.
2-5/64, 1-3/16	2.00" dia. Head recess .05" deep w/2valve reliefs. L19 engine. Destoked .020". Shallow Groove.
1-3/32, 1-5/64, 1-3/16	Flat head w/2 valve reliefs.
2-1.50mm, 1-4.00mm	Flat head. Mitsubishi-G54B.
2-2.00mm, 1-4.00mm	2.670" dia. Head recess .130" deep. NOT AN O.E. DUPLICATE. Replace in Sets.
2-1.50mm, 1-4.00mm	3.07" dia. Head recess .135" deep w/2 valve reliefs. VIN K. Press Fit Pin. Shallow Groove.
2-5/64, 1-3/16	Dome head .095" high w/2 Radius valve reliefs & 1 flat relief. Special High Performance Forged Piston.
2-1.50mm, 1-4.00mm	2.8" dia. Head recess .280" deep w/2 valve reliefs. Turbo. Full floating Pin. Shallow Groove.
2-5/64, 1-3/16	Flat head w/4 valve reliefs. High Performance Piston. Comes with lockrings.
2-1.50mm, 1-3.00mm	Flat Head. 273 cid & 298cid - 3534204 & 3526531 sleeve. 298 cid-Non-Turbo. L26 eng.
2-1.50mm, 1-3.00mm	2.940" dia. Head recess .062" deep. Cadillac Allante w/VIN 8.
2-1.50mm, 1-3.00mm	2.940" dia. Head recess .020" deep. Exc. Cadillac Allante.
2-5/64, 1-3/16	Raised Head .150" deep x 3.260" dia. w/2 valve reliefs. (72-90) Optional for engs. w/68-76cc heads, 305 heads or alum. Corvette heads. (91-96) VIN code "K" w/deep oil ring groove, P3 & G3 series w/Heavy Duty Emmissions. Syclone/Typhoon.
2-1.50mm, 1-4.00mm	2.66" dia, head recess .250" deep w/shallow oil ring groove - low tension ring. VIN W.
2-1.50mm, 1-4.00mm	2.47" dia. Head recess .27" deep. E.F.I., J Body. Shallow Groove.
2-1.50mm, 1-4.00mm	Recessed Head .170" deep with S/C eng.
2-1.50mm, 1-4.00mm	Rectangular Head recess .190" deep. 1993-96 F150 Lightning. 1997 LD Trk.
1-2.00mm, 1-1.5mm, 1-4.00mm	Flat Head w/4 valve reliefs. Piston destoked .020". Cad.-Brougham. Chevy-Corvette. Pontiac-Firebird.
2-1.50mm, 1-3.00mm	2.23" dia. Offset head recess .190" deep, (11cc). Sunbird, non-turbo.
1-1.60mm, 1-1.75mm, 1-3.50mm	2.4" dia. Head recess, .305" deep.
2-1.50mm, 1-4.00mm	2.45" dia. Head recess .030" deep w/4valve reliefs. High Output. Destroked .020". Shallow Groove.
2-1.50mm, 1-3.00mm	Oval head recess .192" deep, (16cc). Code L.
2-1.50mm, 1-3.00mm	Oval Head recess .09" deep. Eagle-Vision. SEFI, OHC. Chrysler-MEFI, OHC.
2-1.50mm, 1-4.00mm	Head recess .124" deep w/2 valve reliefs. 3VZE eng.
2-1.50mm, 1-4.00mm	head recess .240" deep. 4YEC engine.
2-3/32, 2-5/32	Flat head. F6226 engines.
2-3/32, 1-3/16	Flat head.
2-3/32, 1-3/16	Flat head. Truck eng.
2-3/32, 2-5/32	Flat Head. Desoto. Chrysler. Dodge trk.
2-5/64, 1-3/16	Used in either right or left cylinder bank. 3/16" high crown.
2-5/64, 1-3/16	Oblong, recessed head .065" deep.
2-1.50mm, 1-2.80mm	Butterfly shaped recessed head. 4AF & 4AFE engs. 4AGEC, 4AGELC. Use with part number 41482.
2-1.50mm, 1-3.00mm	.157" Recessed Head. 91-94 (Romeo Engine Only). Press Fit pin only. 10.5cc recess.
2-1.20mm, 1-3.00mm	Domed w/4 valve reliefs.
1-2.00mm, 1-1.50mm, 1-4.00mm	Dish recess .073" deep w/4 valve reliefs
2-1.50mm, 1-3.00mm	Replace in Complete sets. Comp. Height does not include .08mm pop up.
2-1.50mm, 1-3.00mm	2.66" dia. Head recess .150" deep w/4 valve reliefs. SOHC. Quad-4 engine, incl. HO. Olds.-Acheiva.
1-1.20mm, 1-1.50mm, 1-3.00mm	3.10" dia. Head recess .295" deep. Shallow Groove. Buick-VIN L. Except supercharged. Chevy-Lumina APV.
2-1.50mm, 1-3.00mm	2.00" dia. Head recess .220" deep. VIN 9.
2-1.50mm, 1-3.00mm	DOHC. 2.70" dia. Head recess .110" deep w/2 valve reliefs. Use early sty ring pick. VIN 7
2-2.00mm, 1-4.00mm	Oval head recess .180" deep w/2 valve reliefs. Screw Type PCV. Truck or Van eng.
1-1.20mm, 1-1.50mm, 1-3.00mm	2.56" dia. Head recess .02" deep. Colt. 4G15 eng.
2-1.50mm, 1-4.00mm	.150" dome with 2 valve reliefs. 4G37 eng. Eagle-Talon.
1-1.20mm, 1-1.50mm, 1-2.80mm	2.346" dia. Head recess .120" deep w/2 valve reliefs. G16KC eng. Exc. California. Geo Tracker, TBI, VIN Q. Suzuki Sidekick G16KC engine, TBI VIN O.
1-1.2mm, 1-1.5mm, 1-2.8mm	Recessed head w/2 valve reliefs 3 ring piston. Suzuki-G10 eng. Sprint, Mark 1-MS, except LSI. Geo-metro, except LSI, FXI. G10 eng.
2-1.50mm, 1-4.00mm	2.75" dia. Head recess .080" deep. VIN S. Camaro & Firebird.
1-3.00mm, 1-2.00mm, 1-4.00mm	Flat head with Ricardo recess .158" deep. Hard Anodized Head. Ni Resist Ring Carrier. Diesel Turbo and Non-Turbo, HO.
2-1.20mm, 1-2.80mm	2.84" dia. Head recess .130" deep w/4 valve reliefs. F22A1 eng. Accord all exc. SE.
1-1.20mm, 1-1.50mm, 1-2.80mm	Flat head w/4 valve reliefs. D15B1/D15B2/D15B6 Civic, CRX OHC eng.
2-1.50mm, 1-4.00mm	Recessed head 4.3mm deep. Isuzu-4ZD1 eng.
2-3/32, 1-3/16	Flat Head.
2-1.50mm, 1-4.00mm	Recessed head 1.4mm deep. 4ZE1 Isuzu eng.
2-3/32, 1-3/16	Flat Head.
2-5/64, 1-3/16	Flat Head.
2-1.50mm, 1-4.00mm	Flat head w/3 valve reliefs. SOHC. Mitsu.- Pickup & Expo. Dodge-RAM 50. Eagle-Summit 1992 116 HP, 1993 136Hp. Dodge Vista
1-1.20mm, 1-1.50mm, 1-3.00mm	Triangular head recess .105" deep w/2 valve reliefs. 6G72 & SOHC 6G72S engs.
2-1.5mm, 1-4.00mm	Rectangular head recess .070" deep. Trucks. JEEP-Grand Cherokee.
1-3.00mm, 1-2.00mm, 1-3.50mm	Swirl Chamber. Truck Diesel. Non-Turbo, not destroked. Iron Top Groove.
1-1.20mm, 1-1.50mm, 1-2.80mm	Circular 3.10" dia. Head recess .150" deep. 4G64 eng. Mitsu.-1994 E56A Galant, DOHC. Dodge-Vista, Eagle-Summit.
1-1.20mm, 1-1.50mm, 1-3.00mm	Recessed head .153" deep.

New CEP#	TC #	Set Qty	Bore (in.)	Bore (mm.)	Comp. Ratio	Comp. Height	Piston Length	Pin Diameter	Head Config.	*Mat'l.	Min. Skirt Clearance	Measure Skirt Clearance at:
224-2912	TC2912	4	3.1890	81.00	9.5:1	1.195	2.35	0.7485	60	-	-	-
224-2913	TC2913020	8	3.800	96.50	9.5:1	1.760	3.35	0.9122	1	-	.0015	.500" up from skirt bottom
224-2914	TC2914	8	4.250	108.00	9.0:1	1.627	3.37	0.9898	81	H	.0020	1.00" up from skirt bottom
224-2915	TC2915	6	3.622	92.00	9.3:1	1.457	2.27	0.9055	11	-	.0015	.250" up from skirt bottom
224-2916	TC2916	4	3.5039	89.00	9.0:1	1.170	2.00	0.8002	3	-	-	-
224-2917	TC2917	4	3.3900	86.00	-	1.358	2.80	0.8650	-	-	.0010	top of skirt slipper
224-2921	TC2921	4	2.992	76.00	-	29mm	2.126	19mm	-	-	.0012	top of skirt slipper
224-2922	TC2922	4	3.5039	89.00	8.6:1	33.7mm	2.697	21mm	4	-	.0012	top of skirt slipper
224-2923	TC2923	4	3.5039	89.00	8.6:1	34mm	2.677	21mm	3	-	.0008	top of skirt slipper
-	TC2924	4	2.9913	74.00	9.2:1	29.5mm	2.362	19mm	88	-	.0012	top of skirt slipper
224-2925	TC2925	4	3.258	82.75	varies	30mm	2.571	20mm	47	-	.0012	top of skirt slipper
224-2927	TC2927	4	2.953	75.00	9.6:1	1.195	2.37	0.748	11	-	.0010	top of skirt slipper
224-2928	TC2928	4	3.5157	88.00	-	1.487	3.150	0.8658	-	-	.0018	top of skirt slipper
224-2929	TC2929	6	3.543	90.00	8.5:1	35.4mm	2.913	23mm	90	-	.0019	top of skirt slipper
224-2930	TC2930	4	3.346	85.00	9.0:1	34.5mm	2.637	21mm	93	-	.0015	top of skirt slipper
224-2932	TC2932	4	3.386	86.00	9.3:1	35mm	2.693	20mm	92	-	.0022	top of skirt slipper
224-2933	TC2933	6	3.268	83.00	9.2:1	33mm	2.795	22mm	95	-	.001	top of skirt slipper
224-2934	TC2934	6	3.268	83.00	8.4:1	33mm	2.795	22mm	96	-	.0015	top of skirt slipper
224-2935	TC2935	6	3.445	87.50	9.0:1	32mm	2.559	21mm	78	-	.0022	top of skirt slipper
224-2938	TC2938	4	2.873	73.00	9.3:1	1.167	2.46	18mm	97	-	.002	top of skirt slipper
224-2940	TC2940	8	4.250	108.00	9.5:1	1.750	3.74	0.9898	106	-	.0015	1.20" Up from bottom
224-2944	TC2944	6	3.800	96.50	8.5:1	1.805	2.98	0.9398	3	H	.0015	bottom of skirt
-	TC2946	6	3.586	91.10	varies	1.247	2.67	0.8665	87	-	.0015	.70" Up from bottom
224-2947	TC2947	6	3.661	93.00	9.3:1	1.510	-	0.9842	1	-	.0020	top of skirt slipper
224-2948	TC2948	8	4.000	101.60	varies	1.540	3.20	0.9273	91	H	.0015	-
-	TC2948A	6	4.000	101.60	varies	1.540	3.20	0.9273	91	H	.0015	.90" Up from bottom
224-2975	TC2975	4	3.339	84.82	-	1.301	-	20.63mm	-	-	.0012	.394" from bottom
224-2976	TC2976	4	3.150	80.00	9.1:1	1.102	2.441	18mm	11	-	.0028	top of skirt slipper
224-2977	TC2977	4	3.2677	83.00	-	1.203	2.400	0.7871	-	-	0.0012	top of skirt slipper
224-2978	TC2978	4	3.150	80.00	-	1.124	2.520	0.7082	-	-	.0013	top of skirt slipper
224-2979	TC2979	4	2.953	75.00	-	1.136	2.180	0.7730	-	-	.0012	top of skirt slipper
224-2980	TC2980	4	3.240	82.30	-	1.288	2.545	0.8266	-	-	.0012	top of skirt slipper
224-2981	TC2981	4	2.953	75.00	-	1.149	2.335	0.7480	-	-	.0012	top of skirt slipper
224-2982	TC2982	4	3.622	92.00	-	1.442	2.930	0.9045	-	-	.0012	top of skirt slipper
224-2983	TC2983	4	2.992	76.00	-	1.154	2.120	0.7480	-	-	.0012	top of skirt slipper
224-2984	TC2984	4	3.385	86.00	-	1.261	2.48	0.8658	1	-	.0012	top of skirt slipper
224-2985	TC2985	4	3.504	89.00	-	1.323	2.67	0.8264	-	-	.0012	top of skirt slipper
224-2986	TC2986	4	3.425	87.00	-	1.283	2.48	0.866	-	-	.0012	top of skirt slipper
224-2987	TC2987	4	2.953	75.00	-	1.183	2.365	0.7476	-	-	.0012	top of skirt slipper
224-2988	TC2988	4	3.346	85.00	-	1.373	2.63	0.826	-	-	.0008	top of skirt slipper
224-2989	TC2989	4	3.189	81.00	-	1.198	2.54	0.7875	-	-	.0012	.375" up from skirt bottom
224-2990	TC2990	8	4.050	102.90	7.21	1.882	3.88	0.9752	39	-	.0020	.875" Up from bottom
224-2991	TC2991	8	3.8976	99.00	-	1.339	-	0.945	1	-	.001	.400" from bottom
224-2992	TC2992	8	4.000	101.60	varies	1.605	3.35	0.9122	42	H	.0015	1.100" Up from bottom
224-3050	TC3050	4	3.405	86.50	8.5:1	35.00mm	2.811	21mm	101	-	.0012	-
-	TC3056	8	4.000	101.60	7.5:1	1.570	3.27	0.9273	102	-	.0015	Bottom of pin boss
-	TC3057	8	3.800	96.50	8.0:1	1.605	3.60	0.9805	103	-	.0015	Bottom of pin boss
224-3058	TC3058	4	2.953	75.00	9.2:1	30mm	2.402	19mm	11	-	.0008	-
224-3061	TC3061	6	4.130	104.90	10.3:1	1.660	-	0.9752	15	-	.0015	Bottom of pin boss
224-3062	TC3062	8	4.000	101.60	8.5:1	1.635	3.24	0.9122	104	-	.0015	Bottom of pin boss
224-3064	TC3064	6	3.6614	93.00	varies	1.535	2.89	0.9450	1	-	.0015	Bottom of pin boss
224-3065	TC3065	4	3.7795	96.00	8.7:1	1.578	2.98	0.9122	8	-	.0015	Bottom of pin boss
224-3066	TC3066	8	4.000	101.60	9.0:1	1.576	3.16	0.9842	1	-	.0015	Bottom of pin boss
-	TC3072	4	4.000	101.60	8.2:1	1.570	3.26	0.9273	3	-	.0025	Bottom of pin boss
224-3075	TC3075	8	4.300	109.00	8.5:1	2.004	3.76	0.9997	26	-	.0010	Bottom of pin boss
224-3076	TC3076	8	4.300	109.00	8.5:1	1.883	3.28	0.9997	26	-	.0010	Bottom of pin boss
224-3078	TC3078	8	3.6614	93.00	10.3:1	1.250	-	0.8665	11	-	-	-
224-3079	TC3079	8	4.050	102.90	7.2:1	1.760	4.167	0.9752	39	-	.0020	Bottom of pin boss
224-3082	TC3082	6	4.000	101.60	varies	1.778	3.17	0.9752	-	H	.0015	Bottom of pin boss
224-3086	TC3086030	6	3.313	84.10	varies	2.000	-	0.8593	1	-	.0015	Bottom of pin boss
224-3089	TC3089	4	3.622	92.00	varies	35mm	2.52	22mm	60	-	.0015	-
224-3097	TC3097	8	4.360	110.70	8.1:1	1.772	3.74	1.040	35	H	.0015	Bottom of pin boss
224-3098	TC3098	6	4.000	101.60	8.3:1	1.778	3.17	0.9752	-	H	.0015	Bottom of pin boss

\*H = Hypereutectic



<u>Rings</u>	<u>Notes</u>
2-1.20mm, 1-2.80mm	Flat head w/2 valve reliefs. 1834cc 4G93 eng. Eagle-Summit, 113HP.
1-5/64, 1-3/32, 1-3/16	Flat Head.
2-5/64, 1-3/16	Flat head w/2 valve reliefs. Used in either right or left cyl. Banks. Not intended for racing applications. Destroyed .020.
2-1.50mm, 1-4.00mm	Flat head w/4 valve reliefs. DOHC. Used in either left or right cylinder bank. Used in sets with early style rings. Pontiac-Grand Prix.
2-1.50mm, 1-3.00mm	Circular 2.94" dia. Head recess .200" deep. 19cc dish vol. VIN 4. Pass. & trk. Chevy-Also 1993 Lumina. Olds.-Cutlass Ciera. Pontiac-Sunfire.
2-1.50mm, 1-4.00mm	Recessed Head w/3 valve reliefs.
2-1.50mm, 1-2.80mm	Bowl Shaped recess 4.8mm deep.
2-1.50mm, 1-2.80mm	Recessed head 0.6mm deep. KA24E 12V eng.
2-1.50mm, 1-2.80mm	Recessed head 0.5mm deep. KA24E 12V eng.
2-1.2mm, 1-2.8mm	Shaped recessed head. 4.5mm deep with 1 valve relief. SETS ONLY. D15A2 eng.
2-1.50mm, 1-4.00mm	Recessed head 2.3mm deep w/4 valve reliefs. A20A3, BS2, BT engs.
1-1.2mm, 1-1.5mm, 1-2.8mm	Flat head w/4 valve reliefs. D15B1/D15B2/D15B6 Civic, CRX OHC eng.
2-1.50mm, 1-4.00mm	Recessed head. 4ZC1 eng.
2-1.50mm, 1-4.00mm	Recessed Head 3.6mm deep w/3 valve reliefs. JEO6, JEO7, JE, JE39 18V engs. Coated Skirt.
1-1.20mm, 1-1.50mm, 1-3.00mm	Recessed head 2.38mm deep w/4 valve reliefs. 4G63, A, G4CP, DOHC 16V engs.
2-1.50mm, 1-4.00mm	3SFE 16V eng.
2-1.50mm, 1-4.00mm	Special shaped head recess 3.2mm deep w/4 valve reliefs. 7MGE 24V eng.
2-1.50mm, 1-4.00mm	Recessed head 5.8mm deep w/4 valve reliefs. 7MGTE 24V eng.
2-1.50mm, 1-3.00mm	Recessed head 2mm deep. W/4 valve reliefs. Toyota-2VZFE 24V eng., (Lexus ES250 1990-91).
2-1.50mm, 1-3.00mm	Special Shaped Head Recess. 3EE Tercel eng.
2-5/64, 1-3/16	.140" crown. Used in either left or right cylinder bank
2-5/64, 1-3/16	3.05" dia. Head recess .235" deep. Destroyed .020". Non-turbo. VIN A.
2-1.50mm, 1-4.00mm	Triangular head recess .108" deep w/2 valve reliefs. Chrysler-6G72 eng. Stealth, SOHC. Hyundai-G6AT Sonata, EFI
2-1.50mm, 1-4.00mm	Flat Head. VIN U.
2-5/64, 1-3/16	3.14" dia. Head recess .07" deep w/4 valve reliefs, (12cc). Use 1986 & earlier rings. Not intended for racing applications. Destroyed .020" GMC Trk.-Deep Groove.
2-5/64, 1-3/16	(same as 2948. see above.)
1-1.50mm, 1-1.75mm, 1-3.00mm	Dome head 1.26mm high, with valve reliefs, 2 are 5.23mm deep, and one is 6.47mm deep.
2-1.20mm, 1-3.00mm	Flat Head w/ 4 valve reliefs. RF 12V Geo Storm eng. Isuzu Stylus 4XE1 12V eng.
2-1.50mm, 1-3.00mm	Raised head with 4 valve reliefs.
2-1.20mm, 1-3.00mm	Raised head w/ 4 valve reliefs.
1-1.20mm, 1-1.50mm, 1-2.80mm	Recessed head w/4 valve reliefs in recess.
1-1.20mm, 1-1.50mm, 1-3.00mm	Raised head with 4 valve reliefs.
1-1.20mm, 1-1.50mm, 1-2.80mm	Recessed head w/4 valve reliefs in recess.
2-1.50mm, 1-4.00mm	Concave head.
2-1.50mm, 1-2.80mm	Concave head.
2-1.50mm, 1-3.00mm	Flat Head.
2-1.50mm, 1-2.80mm	Concave head.
2-1.50mm, 1-4.00mm	Recessed head w/4 valve reliefs.
1-1.20mm, 1-1.50mm, 1-2.80mm	Raised head w/ 4 valve reliefs.
1-1.20mm, 1-1.50mm, 1-3.00mm	Recessed head w/4 valve reliefs in recess. Turbo 4G63 eng.
1-1.20mm, 1-1.50mm, 1-2.80mm	Raised head w/4 valve reliefs.
1-3/32, 1-5/64, 1-3/16	2.6" dia. Head recess .17" deep. 359/361 Trk. Eng. After Engine U40000. 3 rings.
2-1.50mm, 1-3.00mm	Flat head w/ reliefs
2-5/64, 1-3/16	Flat top w/4 valve reliefs. Not intended for racing applications. Not destroyed.
2-1.50mm, 1-4.00mm	Recessed head .38mm deep w/ 3 valve reliefs. Hyundai Sonata G4CS eng., Mitsu-Expo 4G84 8V eng., Mitsu-Galant & Van G64B eng., Chrysler-Colt Vista T & 4G64 eng., Chrysler-RAM 50, Power Ram 50 pickup T & 4G64 eng.
2-5/64, 1-3/16	LU8 eng., Turbo. Shallow Groove. Right & Left cyl. Bank set.
2-5/64, 1-3/16	Recessed head .270" deep. Left and right cyl. Bank set.
1-1.20mm, 1-1.50mm, 1-2.80mm	Flat head w/ 4 valve reliefs. D15B1 16V Civic eng.
2-5/64, 1-3/16	2.593" dia. Head recess .125" deep w/4 valve reliefs. Pin I.D. .70" Cobra Jet.
2-5/64, 1-3/16	Flat head with 2 angled valve reliefs. Cleveland eng.
1-2.0mm, 1-2.5mm, 1-4.00mm	Flat head. Capri, Mustang II (1976-79), Ranger (1983-85)
2-1.5mm, 1-4.00mm	Flat Head w/2 valve reliefs. Shallow Groove.
2-5/64, 1-3/16	Flat head.
2-5/64, 1-3/16	3.02" dia. Head recess .226" deep. Replace in full sets only. Chevy-Citation. Buick-Skylark.
2-5/64, 1-3/16	Rectangular head recess .380" deep.
2-5/64, 1-3/16	Head recess 13/32" deep. 50cc dish.
2-1.5mm, 1-3.00mm	Flat head w/4 valve reliefs. Cadillac North Star System. Chevy-Camaro Z28. Cad.-VIN 9 and Y. L37 eng. 270 and 295 HP.
1-3/32, 2-5/64, 1-3/16	3" dia. Head recess .31" deep. Iron Top Groove. Can be replaced by 224--2004. Truck eng., not destroyed.
2-5/64, 1-3/16	2.7" dia. Head recess .215" deep. Special Heavy UPS type service.
1-5/64, 2-3/32, 1-1/4	F226 & F227 engines. Flat Head.
2-1.50mm, 1-4.00mm	Recessed Head 2.2mm deep w/1 valve relief.
2-5/64, 1-3/16	.240" deep w/2 valve reliefs. Car & trk. Non-EFI. Not destroyed.
2-5/64, 1-3/16	3.0" dia. Head recess .240" deep. Special step quench head for heavy UPS type service.

New CEP#	TC #	Set Qty	Bore (in.)	Bore (mm.)	Comp. Ratio	Comp. Height	Piston Length	Pin Diameter	Head Config.	*Mat'l.	Min. Skirt Clearance	Measure Skirt Clearance at:
224-3099	TC3099	8	3.551	90.20	varies	1.200	2.19	0.8665	4	H	.0015	Bottom of pin boss
224-3101	TC3101	8	3.937	100.00	varies	2.160	3.41	0.9898	-	H	.0020	Bottom of pin boss
224-3107	-	4	3.875	98.40	4.2:1	1.906	-	0.9997	1	-	.0020	Bottom of pin boss
224-3108	TC3108	4	3.1732	80.60	8.2:1	1.455	-	0.8662	-	-	-	-
224-3110	TC3110	4	3.779	96.00	varies	46.40mm	3.007	24mm	1	-	.0004	3.25" below centerline
224-3118	TC3118	6	3.267	83.00	8.9:1	38mm	2.559	20mm	3	-	.0004	3.25" below centerline
224-3120	TC3120	4	3.425	87.00	8.5:1	35.50mm	2.397	21mm	47	-	.0012	3.25" below centerline
224-3123	TC3123	6	3.875	98.40	7.2:1	1.935	3.62	0.9273	19	-	.0025	Bottom of pin boss
224-3129	TC3129	4	3.228	82.00	varies	1.474	2.68	0.9055	1	-	.0010	Bottom of pin boss
224-3132	TC3132	8	3.500	88.90	9.6:1	1.843	3.03	0.8750	3	-	.0015	Bottom of pin boss
224-3133	TC3133	4	3.622	92.00	9.0:1	1.536	3.64	0.8665	-	H	.0015	Bottom of pin boss
224-3134	TC3134	4	2.9134	74.00	8.2:1	1.100	2.181	0.6692	86	-	.0012	-
224-3163	TC3163	8	4.110	104.40	varies	2.142	3.789	1.3085	-	-	.0055	.850" from bottom
224-3173	TC3173	8	4.125	104.80	varies	1.747	3.720	0.9898	106	-	.0015	Bottom of pin boss
224-3174	TC3174	4	3.586	91.10	8.2:1	1.365	3.02	0.8665	3	H	.0015	Bottom of pin boss
224-3175	TC3175	6	4.000	101.60	varies	1.540	2.42	0.9273	91	H	.0015	Bottom of pin boss
-	TC3175A	8	4.000	101.60	varies	1.540	2.42	0.9273	91	H	.0015	Bottom of pin boss
224-3176	TC3176	6	3.800	96.50	-	1.446	-	0.9054	3	H	.0015	Bottom of pin boss
224-3177	TC3177	6	4.000	101.60	8.7:1	1.780	3.38	0.9752	13	-	4.000	Bottom of pin boss
224-3178	TC3178	4	3.586	91.10	8.2:1	1.418	3.07	0.8665	1	-	.0015	Bottom of pin boss
224-3179	TC3179	4	3.425	87.00	varies	1.438	3.13	0.8665	1	-	.0015	Bottom of pin boss
224-3180	TC3180	8	4.360	110.70	varies	1.760	3.27	1.04	35	-	.0015	Bottom of pin boss
224-3181	TC3181	4	3.5039	89.00	9.0:1	1.170	-	0.8002	16	H	-	Bottom of pin boss
224-3183	TC3183	8	4.110	104.39	-	1.950	3.46	1.3085	-	-	.006	1.00" from bottom
224-3184	TC3184	8	3.910	99.31	-	1.730	3.435	0.984	1	-	.0010	1.00" Up from bottom
224-3287	TC3287	4	3.438	87.30	varies	1.998	-	0.8593	1	-	.0020	Bottom of pin boss
224-3401	TC3401	4	3.6220	92	7.5:1	1.355	2.49	0.8665	-	-	.0025	Bottom of pin boss
224-3402	TC3402	8	4.000	101.6	9.1:1	1.54	2.42	0.9273	91	H	.0015	Bottom of pin boss
-	TC3402A	6	4.000	101.6	9.1:1	1.54	2.42	0.9273	91	H	.0015	Bottom of pin boss
224-3403	TC3403	8	4.054	102.981	-	2.109	3.619	1.22	-	H	.004	.63" from bottom
224-3404	TC3404	6	3.8122	96.83	9.3:1	1.255	2.55	0.9054	-	H	.0017	Bottom of pin boss
224-3405	TC3405	4	3.445	87.5	9.8:1	1.23	2.52	0.8267	-	-	.0010	-
224-3406	TC3406	6	3.38	86	-	1.222	2.0965	0.8662	1	H	-	1.66" Down from top
224-3407	TC3407	6	3.7992	96.5	9.2:1	1.09	2.09	0.8662	17	H	.0015	-
224-3408	TC3408	6	3.9100	99.3	9.0:1	1.741	3.43	0.9842	1	H	-	-
224-3409	2243409	8	4.110	104.40	varies	2.132	3.619	1.3085	-	-	.0055	.850" from bottom
224-3410	TC3410	8	4.110	104.40	-	2.14	3.778	1.306	-	-	.0067	.850 up from bottom
224-3411	TC3411	6	3.5039	89.0	9.5:1	1.476	2.304	0.9054	-	-	-	-
224-3412	TC3412	6	3.6220	92.0	9.5:1	1.47	2.462	0.9054	-	-	-	-
224-3413	TC3413	8	3.552	90.2	-	1.216	2.036	0.866	3	-	.0014	.354 from bottom
224-3414	TC3414	8	3.552	90.2	9.0:1	1.223	2.048	0.864	3	-	.0014	.354 from bottom
-	TC3414A	10	3.552	90.2	9.0:1	1.223	2.048	0.864	3	-	.0014	.354 from bottom
224-3417	TC3417	8	3.552	90.2	-	1.246	2.049	0.862	3	-	.0014	.354 from bottom
224-3418	TC3418	8	3.552	90.2	-	1.2215	2.04	0.863	3	-	.0014	.354 from bottom
-	TC3418A	10	3.552	90.2	-	1.2215	2.04	0.863	3	-	.0014	.354 from bottom

<u>Rings</u>	<u>Notes</u>
2-1.5mm, 1-3.00mm	2.70" dia. Head recess .157" deep. Destroyed .020". SOHC. Press Fit pin.
1-3/32, 2-5/64, 1-3/16	.95" Dome with one valve relief. Except H5D. Not destroyed. Shallow Groove.
2-5/64, 1-3/16	Flat head. Model A.
1-1.75mm, 1-2.00mm, 1-4.00mm	.170" Recessed head w/1 valve relief. Peugeot E82 eng.
1-1.75mm, 1-2.00mm, 1-4.00mm	Flat Head. Volvo 2316cc
2-1.50mm, 1-4.00mm	Recessed head 0.8mm deep. 7/1981-1984 Maxima 6 cyl. L24E eng.
2-1.50mm, 1-4.00mm	Z22, Z22E 200SX, 720 engs.
2-3/32, 1-3/16	Head recess .234" deep. Trk. Engine. Low compression export piston.
2-2.0mm, 1-4.00mm	Flat Head. For Brazilian Expot.
2-5/64, 1-3/16	2.68" dia. Head recess by .091" deep. High comp. Land Rover & Triumph also.
1-2.00mm, 1-2.5mm, 1-4.00mm	Crown .25" high & 2.30" dia. Head recess .20" deep. 22R engine., not destroyed
1-1.20mm, 1-1.50mm, 1-2.80mm	Recessed Head w/2 valve reliefs.
1-3.00mm, 1-2.00mm, 1-3.50mm	Recessed "Reentrant Bowl type" combustion bowl .67" deep. Powerstroke Direct Injection Turbo Diesel. Ni Resist Ring Carrier.
2-5/64, 1-3/16	396 cid-Used in either left or right cylinder bank. .132" hi crown. Use Std. Oversize for .030 o/s 396 application. Not destroyed. 402 cid-Big Block 132" crown. Used in either left or right cyl. Bank. Not Destroyed.
2-1.5mm, 1-4.0mm	1976-1987 Non-Turbo. 1984-1987 EFI. 1984-1989 Turbo. F and W engs. 2.75" dia. Head recess .200" deep. Destroyed .010".
1-2.0mm, 1-1.5mm, 1-4.0mm	3.10" dia. Head recess .80" deep w/4 valve reliefs. LT. WT. For VIN W 1995-1998, 1996-1997 VIN X, & 1995-1996 VIN Z stamped AA. Destroyed .020". Shallow Groove.
1-2.0mm, 1-1.5mm, 1-4.0mm	3.10" dia. Head recess .80" deep w/4 valve reliefs. Destroyed .020". Shallow Groove.
1-1.2mm, 1-1.5mm, 1-3.0mm	3.10" dia. Head recess .295" deep. VIN L. Except Supercharged. Shallow Grove.
2-5/64, 1-3/16	3.125" dia. "D" shaped recess .300" deep. VIN Y. Trk. Eng, EFI, Destroyed .010"
2-1.5mm, 1-4.0mm	Flat Head, non-turbo w/carb. To 1-19-1989.
2-2.0mm, 1-4.0mm	Chevy- S10 pickup with LR1 eng. 22mm pin. ISUZU-G200Z Eng. Trooper II & pickup. BOTH-Flat head. Use 1982 ring pack for all years. 22MM pin.
2-5/64, 1-3/16	Oblong head recess .072" deep w/2valve reliefs. EFI, VIN G.
2-1.50mm, 1-3.00mm	VIN 4. Circular 2.94" dea. Head recess .200" deep. 19cc dish vol.
1-3.00mm, 1-2.00mm, 1-3.50mm	Flat top w/6.7cc Ricardo Cup, Ni Risist ring carrier.Hard Anodized Crown. Factory Indirect Injection Turbo Diesel, Big Pin.
2-5/64, 1-3/16	Flat Top.
1-5/64, 2-3/32, 1-1/4	F6226 & F245 engines. Flat Head.
2-1.50mm, 1-4.00mm	22RTEC Turbo SOHC eng. 4-Runner & Pickup. 2.900" dia. Head recess .218" deep w/2 valve reliefs.
2-1.50mm, 1-3.00mm	3.100" Dia. Head recess .080" deep w/4 Valve Reliefs. VIN "W" & "Z" -262 CID. VIN "K" (L36) & "R" (L31) -350 CID. Shallow Groove. Not intended for Racing Applications. For use with ring set 41785
2-1.50mm, 1-3.00mm	3.100" Dia. Head recess .080" deep w/4 Valve Reliefs. VIN "W" & "Z" -262 CID. VIN "K" & "R"-350 CID. Shallow Groove. Not intend ed for Racing Applications. For use with ring set 41786
1-3.00mm, 2-2.00MM, 1-4.00mm	Ricardo Bowl Head .148" Deep. Ni-Resist Ring Carrier. Reduced Compression Height by .010" to allow for block milling.
2-1.50mm, 1-3.00mm	Oblong Head Recess .150" Deep. Use w/ Ring set# 41732
2-1.20mm, 1-3.00mm	2.600" Dia. Head recess .015" deep. SOHC. VIN "C" & "N".
2-1.50mm, 1-3.00mm	Flat Top. Coated Piston Skirt. Use w/ring set# 41855CP.
1-1.20mm, 1-1.50mm, 1-2.00mm	2.860" dia. Recessed Head, .05" Deep. V IN "K". Not intended for racing applications. Use w/ Ring Set# 41847CP.
2-2.00mm, 1-4.00mm,	Flat Head. Shallow Groove. Use w/Ring set# 41708
1-3.00mm, 1-2.00mm, 1-3.50mm	Recessed "Reentrant Bowl type" combustion bowl .67" deep. Powerstroke Direct Injection Turbo Diesel. Ni Resist Ring Carrier. Same as 224-3163 except Reduced Compression distance by .010" to allow for deck milling.
1-3.00mm, 1-2.00mm, 1-3.45mm	Recessed "Reentrant Bowl type" combustion bowl. Keystone Top Ring. 2nd Groove is a gas accumulator ring. Free Floating pin (comes with Lockrings).
1-1.20mm, 1-1.50mm, 1-3.00mm	2.825" dia. Head recess .258" deep. Coated Skirt. Shallow Groove. VIN "M" & "K".
1-1.20mm, 1-1.50mm, 1-4.00mm	3.140" dia. Head recess .270" deep. Coated Skirt. Vin "E", LA1 eng.
2-1.50mm, 1-3.00mm	2.931" Dia. Recessed Head X .193" deep. Shallow Top Groove .131". Coated Skirt. Use with ring set# 41546.
2-1.50mm, 1-3.00mm	Recessed Head 2.701" dia. X .063" deep. Free Floating pin (comes with Lockrings). Coated Skirt. SOHC NPI.
2-1.50mm, 1-3.00mm	Recessed Head 2.701" dia. X .063" deep. Free Floating pin (comes with Lockrings). Coated Skirt. SOHC NPI.
2-1.50mm, 1-3.00mm	2.642" dia. Recessed head X .162". Coated Skirt. Shallow Top Groove .131". Use w/ring set# 41546
2-1.500mm, 1-3.00mm	2.951" Dia Recessed Head X .132" deep. Coated Skirt. Use with ring set# 41787 (8pk.).
2-1.500mm, 1-3.00mm	2.951" Dia Recessed Head X .132" deep. Coated Skirt. Use with ring set# 41788 (10pk.)