



HARNESS SYMBOL :  (F)  (E)  (D)  (R)

**CRANKSHAFT POSITION SENSOR**  
Uses the magnetic pickup sensor. Detects crankshaft position and sends signal to PCM.

[GRAY]  
CRANKSHAFT POSITION SENSOR  
B2-05

[BLACK]  
CAMSHAFT POSITION SENSOR  
B2-32

**CAMSHAFT POSITION SENSOR**  
Uses the magnetic pickup sensor. Detects camshaft position and sends signal to PCM.

[BLACK]  
CAPACITOR  
B2-03

MAIN FUSE  
X-01

**MAIN FUSE BLOCK**

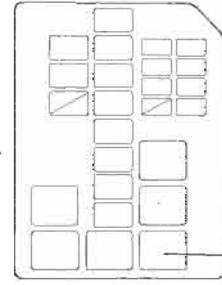

←  
FRONT

MAIN RELAY

B2-04  
KNOCK SENSOR  
[GRAY]

**KNOCK SENSOR**  
Detects knocking and sends signal to PCM.

B2-33  
IGNITION COIL  
**IGNITION COIL**  
Provides high voltage pulse to spark plugs.

WITH ABS → ①  
WITHOUT ABS → ①

X-06  
(F)-(EM)

Z-31

DIODE  
B2-34

(F)-(I)  
X-08

(EM)-(D)  
X-15

(EM)-(I)  
X-13

DATA LINK CONNECTOR  
B2-30

(F)-(I)  
X-08

[BLUE]  
(F)-(D)  
X-05

IGNITION SWITCH  
X-03

JOINT BOX  
(REFER TO JB SECTION)

B2-01  
PCM  
**PCM**  
Uses information from various sensors/actuators to control powertrain (engine/transaxle) operation.

X-11  
JOINT CONNECTOR

(F)-(I)  
X-08

X-13  
(EM)-(I)

WIRING DIAGRAM Z

B-2a

# EC-AT CONTROL SYSTEM (KL) / ENGINE CONTROL SYSTEM (KL)

B-2b

Z WIRING DIAGRAM

Z-32

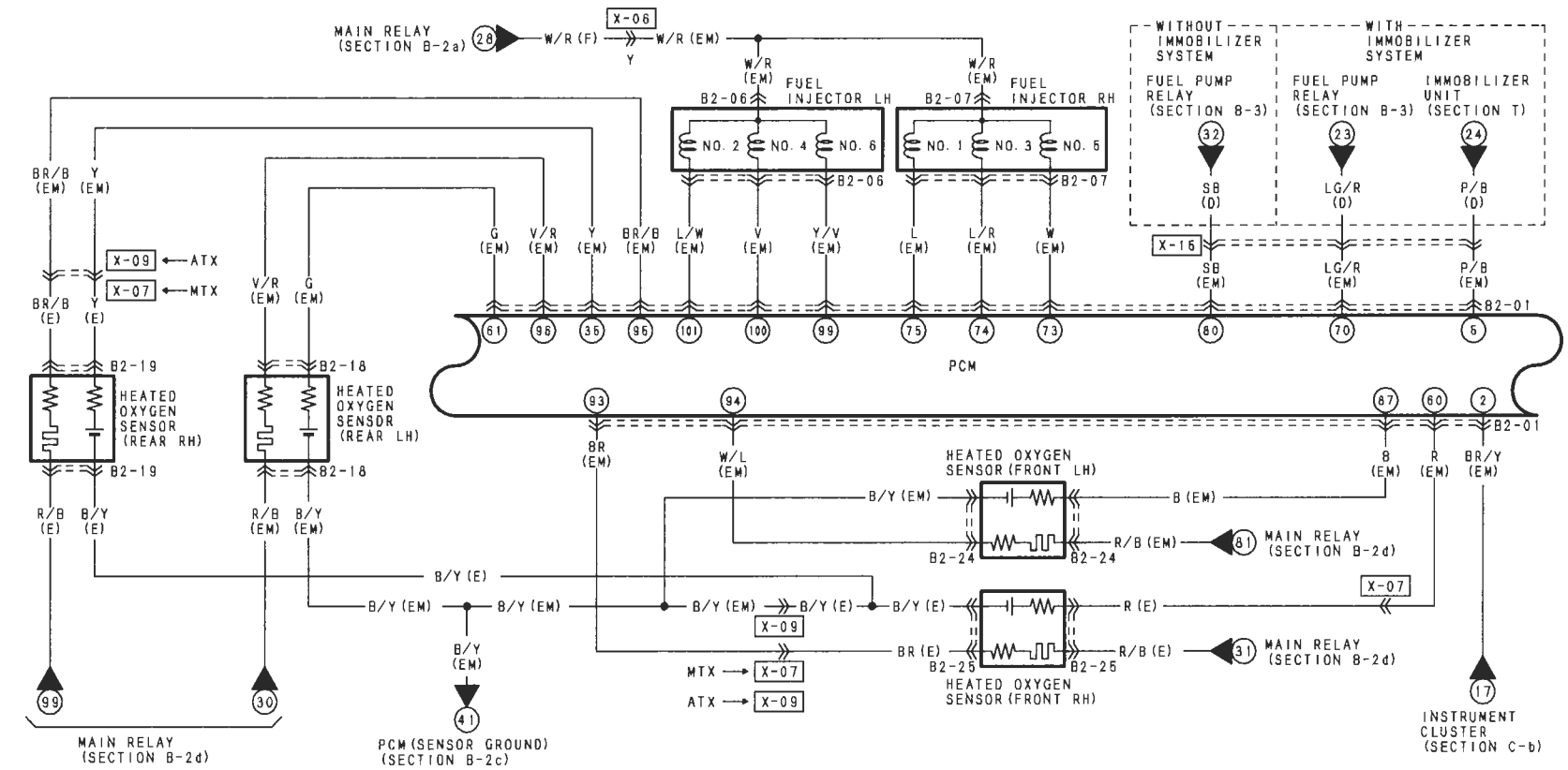

B2-01 PCM (EM)

26	25	24	23*	22	21	20	19	18	17	16	15	14	13	12	11	10	9*	8	7*	6*	5	4	3	2	1*
R	*	B/L	<W>	G	L	L/D	L/Y	LG	GY	P	L	#	V	*	BR/W	V/W	<LG/B>	L	<L/O>	<R/L>	P/B	*	*	BR/Y	<L/B>
52	51	50	49	48	47	46	45	44	43	42	41	40	39	38	37*	36	35	34	33	32*	31	30	28*	28*	27*
W	B/L	*	R/W	O/B	*	P/B	L/B	W/B	*	G/O	V/R	*	G/W	D/L	<GY>	BR/R	Y	Y/B	R/B	<R/Y>	L/Y	<#>	<BR/B>	<G/B>	<L>
78	77	76	75	74	73	72	71	70	69	68	67	66	65	64<O>	63	62	61	60	59	58	57	56	55	54*	53*
B	B/L	B/R	L	L/R	W	R/Y	R/B	LG/R	GY/B	G	Y/L	O	* LG/B	G/Y	P/G	G	R	*	GY/L	W	D/B	L/R	<LG/R>	<G>	
104	103	102	101	100	99	98	97	96	95	94	93	92*	91	90	89	88	87	86	85	84*	83	82	81*	80	79*
*	B/L	*	L/W	V	Y/V	W/R	R/B	V/R	BR/B	W/L	BR	<W/G>	B/Y	GY/R	V/Y	R/G	B	*	P	<B>	G/R	P/B	<L/W>	SB	<GY/B>

B2-06 FUEL INJECTOR LH (EM)

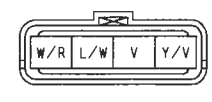

B2-07 FUEL INJECTOR RH (EM)



B2-18 HEATED OXYGEN SENSOR (REAR LH) (EM)

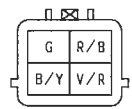

B2-19 HEATED OXYGEN SENSOR (REAR RH) (E)

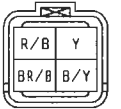

B2-24 HEATED OXYGEN SENSOR (FRONT LH) (EM)

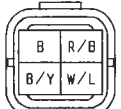

B2-25 HEATED OXYGEN SENSOR (FRONT RH) (E)

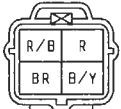

**FUEL INJECTOR**  
Controlled by PCM meters fuel to engine.

[GRAY]  
FUEL INJECTOR RH  
B2-07

[GRAY]  
FUEL INJECTOR LH  
B2-06

[BLACK]  
(EM)-(E)  
X-09

[BLACK]  
(EM)-(E)  
X-07

[BLACK]  
HEATED OXYGEN SENSOR  
(FRONT RH)  
B2-25

**HEATED OXYGEN SENSOR**  
Upstream side to catalytic converter:  
Detects exhaust gas condition (Air/Fuel ratio)  
and sends signal to PCM.  
Downstream side to catalytic converter:  
Detects deterioration of catalytic converter.

B2-19  
HEATED OXYGEN SENSOR  
(REAR RH)

B2-24  
HEATED OXYGEN SENSOR  
(FRONT LH)  
[BLACK]

X-06  
(F)-(EM)

B2-18  
HEATED OXYGEN SENSOR  
(REAR LH)

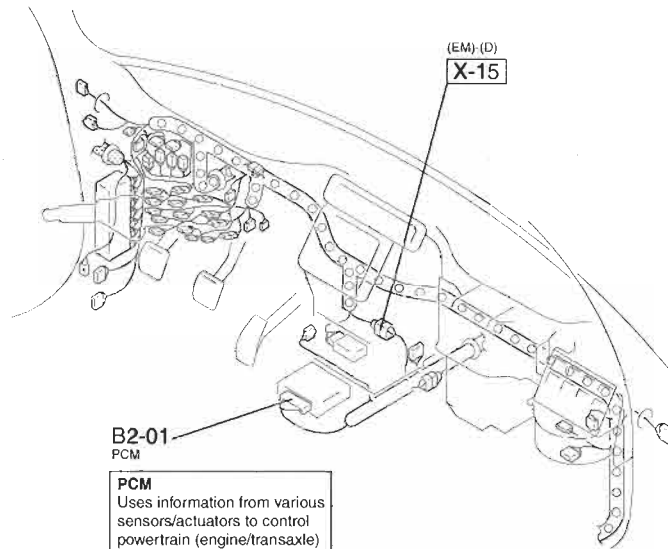

**PCM**  
Uses information from various  
sensors/actuators to control  
powertrain (engine/transaxle)  
operation.

Z-33

WIRING DIAGRAM Z

# EC-AT CONTROL SYSTEM (KL) / ENGINE CONTROL SYSTEM (KL)

B-2c

Z WIRING DIAGRAM

< > ATX

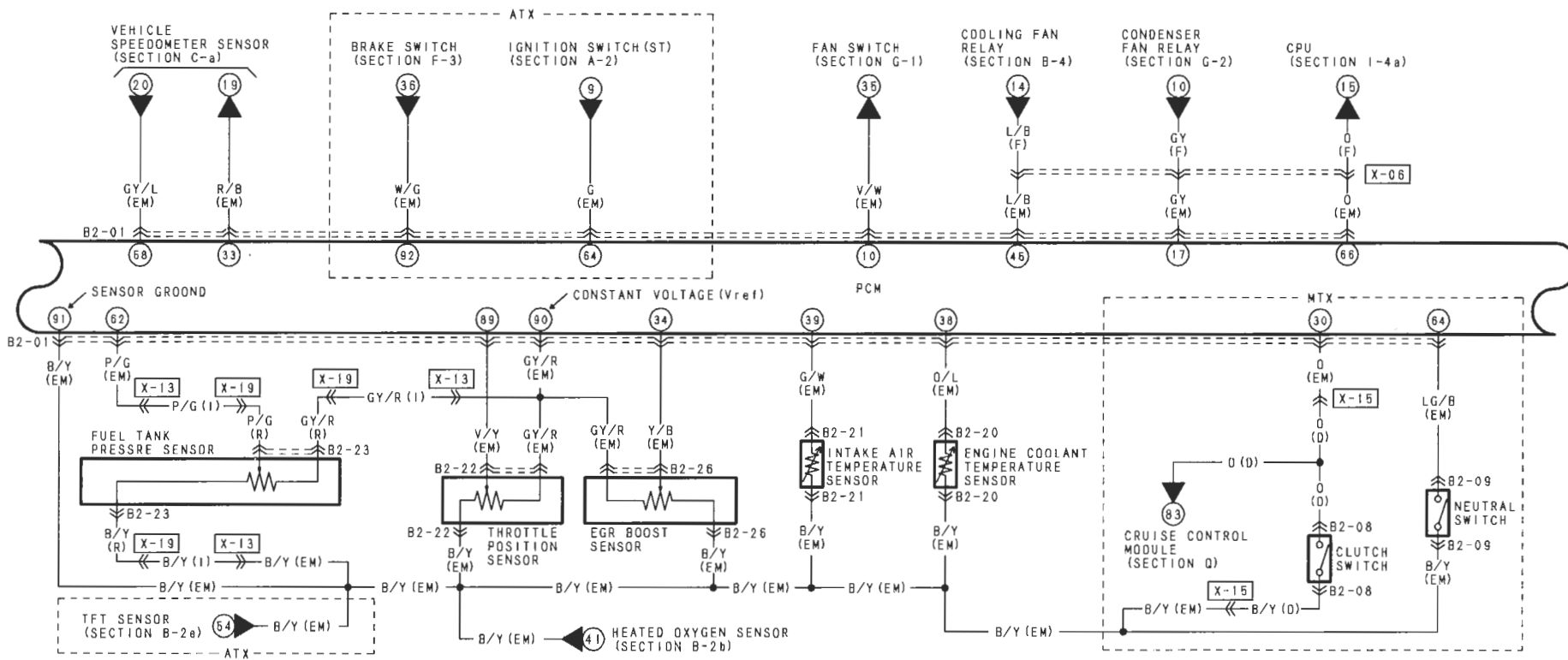

B2-01 PCM (EM)

26	25	24	23*	22	21	20	19	18	17	16	15	14	13	12	11	10	9*	8	7*	6*	5	4	3	2	1*
R	*	B/L	<W>	G	L	I/D	L/Y	LG	Y	P	L	*	V	*	BR/W	V/W	<LG/B>	L	<L/O>	<R/L>	P/B	*	*	BR/Y	<L/B>
52	51	50	49	48	47	46	45	44	43	42	41	40	39	38	37*	36	35	34	33	32*	31	30	29*	28*	27*
W	B/L	*	R/W	O/B	*	P/B	L/B	W/B	*	G/D	V/R	*	G/W	Q/L	<GY>	BR/R	Y	Y/B	R/B	<R/Y>	L/Y	<*>	BR/B	<G/B>	<L>
78	77	76	75	74	73	72	71	70	69	68	67	66	65	64	63	62	61	60	59	58	57	56	55	54*	53*
B	B/L	B/R	L	L/R	W	R/Y	R/B	LG/R	GY/B	G	Y/L	O	* LG/B	G/Y	P/G	G	R	*	GY/L	W	O/B	L/R	<LG/R>	<G>	
104	103	102	101	100	99	98	97	96	95	94	93	92*	91	90	89	88	87	86	85	84*	83	82	81*	80	79*
*	B/L	*	L/W	V	Y/V	W/R	R/B	V/R	BR/B	W/L	BR	<W/G>	B/Y	GY/R	V/Y	R/G	B	*	P	<B>	G/R	P/B	<L/W>	S/B	KGY/B

B2-08 CLUTCH SWITCH (D)

B2-09 NEUTRAL SWITCH (EM)

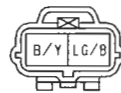
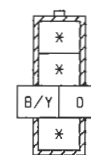

(MTX)

(MTX)

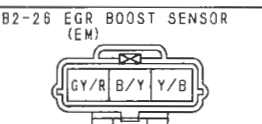
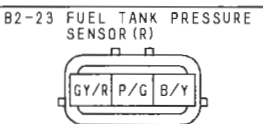
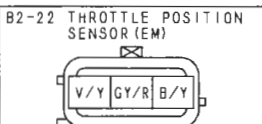
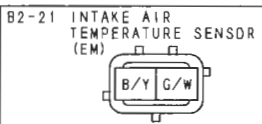
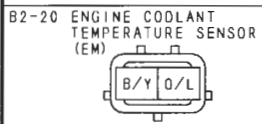

HARNESS SYMBOL :  (F)  (E)  (D)  (R)

**ENGINE COOLANT TEMPERATURE SENSOR**  
Detects engine coolant temperature and sends signal to PCM.

ENGINE COOLANT TEMPERATURE SENSOR  
B2-20

[GRAY]  
EGR BOOST SENSOR  
B2-26

THROTTLE POSITION SENSOR  
B2-22

**THROTTLE POSITION SENSOR**  
Detects throttle opening angle and sends signal to PCM.

INTAKE AIR TEMPERATURE SENSOR  
B2-21

**INTAKE AIR TEMPERATURE SENSOR**  
Detects intake air temperature and sends signal to PCM.

[BLACK]  
CLUTCH SWITCH  
B2-08

**CLUTCH SWITCH**  
Opened with clutch pedal depressed, Sends signal to PCM, ABS control module.

(EM)-(D)  
X-15

(EM)-(I)  
X-13

B2-09  
NEUTRAL SWITCH  
[BLACK]

**NEUTRAL SWITCH**  
Opened when gear is in neutral position or clutch pedal is depressed. Sends signal to PCM, ABS control module.

B2-01  
PCM

**PCM**  
Uses information from various sensors/actuators to control powertrain (engine/transaxle) operation.

X-06  
(F)-(EM)

X-19  
(I)-(R)

X-13  
(EM)-(I)

(I)-(R)  
X-19

B2-23  
FUEL TANK PRESSURE SENSOR  
[BLACK]  
(NOTE: ABOVE THE REAR CROSSMEMBER)

**FUEL TANK PRESSURE SENSOR**  
Detects fuel tank pressure and sends signal to PCM. This signal is used for evaporative system monitoring.

# EC-AT CONTROL SYSTEM (KL) / ENGINE CONTROL SYSTEM (KL)

B-2d

Z WIRING DIAGRAM

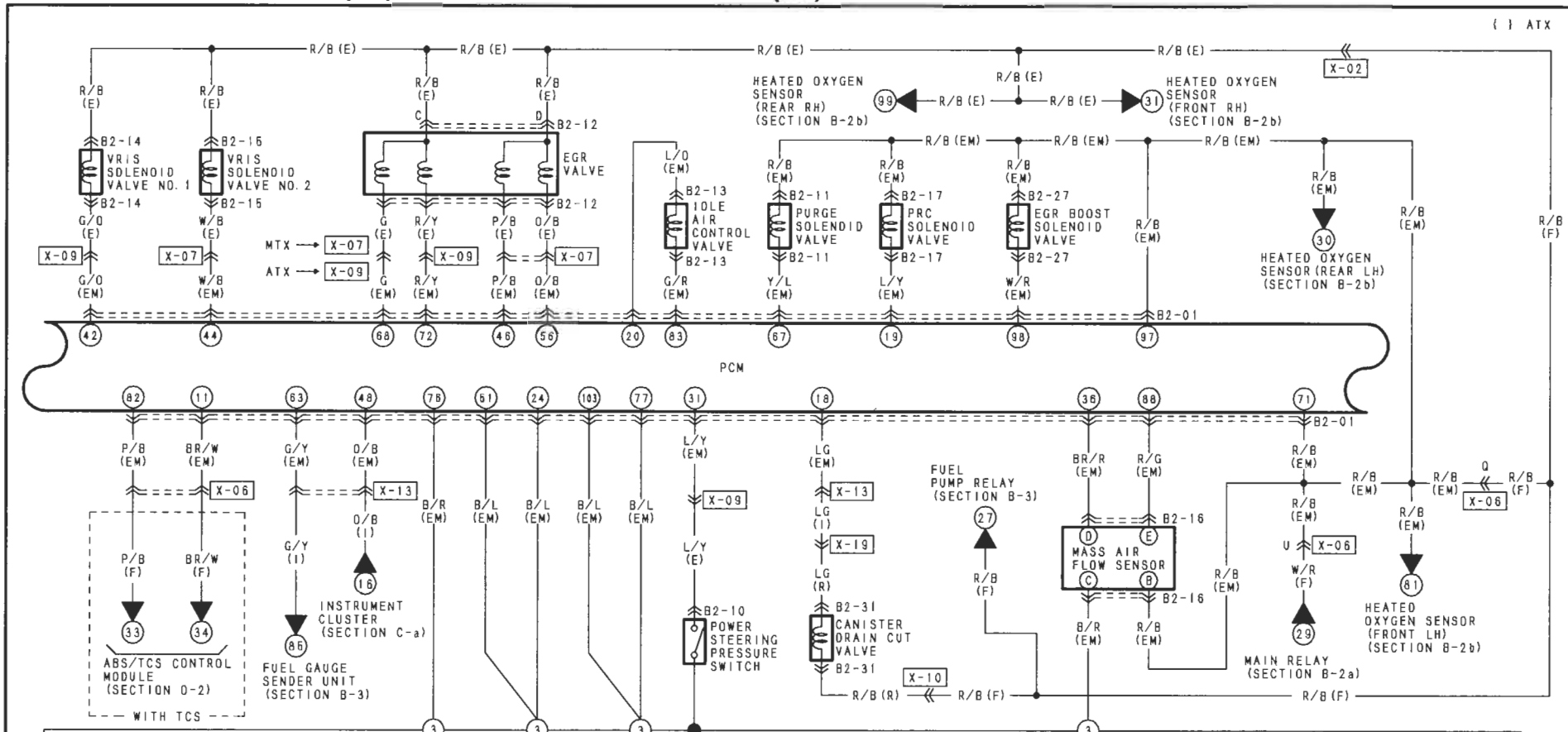

Z-36

B2-01 PCM (EM)													B2-10 POWER STEERING PRESSURE SWITCH (E)		B2-11 PURGE SOLENOID VALVE (EM)																																																														
26	26	24	23*	22	21	20	19	18	17	16	15	14	13	12	11	10	9*	8	7*	6*	5	4	3	2	1*	L/Y		Y/L R/B																																																	
R	*	B/L	<W>	G	L	L/O	L/Y	LG	GY	P	L	*	V	*	BR/W	V/W	<L/G/B>	L	<L/O>	<R/L>	P/B	*	*	*	BR/Y	<L/B>																																																			
52	51	50	49	48	47	46	45	44	43	42	41	40	39	38	37*	36	35	34	33	32*	31	30	29	28*	27*																																																				
W	B/L	*	R/W	O/B	*	P/B	R/L	B/W	*	G/O	V/R	*	G/W	O/L	<G/Y>	BR/R	Y	Y/B	R/B	<R/Y>	L/Y	<*>	<BR/B>	<G/B>	<L>																																																				
78	77	76	75	74	73	72	71	70	69	68	67	66	65	64	63	62	61	60	59	58	57	56	55	54*	53*																																																				
B	B/L	B/R	L	L/R	W	R/Y	R/L	B/R	LG	R/G	Y/B	G	Y/L	O	* LG/B	G/Y	P/G	G	R	G/L	W	O/B	L/R	<L/G/R>	<G>																																																				
104	103	102	101	100	99	98	97	96	95	94	93	92*	91	90	89	88	87	86	85	84*	83	82	81*	80	79*																																																				
*	B/L	*	L/W	V	Y/V	W/R	R/B	V/R	BR/B	W/L	BR	<W/G>	B/Y	GY/R	V/Y	R/G	B	*	P	<B>	G/R	P/B	<L/W>	SB	<G/Y>																																																				
B2-14 VRIS SOLENOID VALVE NO. 1 (EM)													B2-15 VRIS SOLENOID VALVE NO. 2 (EM)													B2-16 MASS AIR FLOW SENSOR (EM)													B2-17 PRC SOLENOID VALVE (EM)													B2-27 EGR BOOST SOLENOID VALVE (EM)													B2-31 CANISTER DRAIN CUT VALVE (R)												
G/O R/B													W/B R/B													R/G BR/R B/R R/B													L/Y R/B													W/R R/B													LG R/B												

HARNESS SYMBOL :  (F)  (E)  (D)  (R)

**POWER STEERING PRESSURE SWITCH**  
Power steering pressure switch signals PCM to increase idle speed to prevent engine from stalling.

POWER STEERING PRESSURE SWITCH  
B2-10

[BLUE]  
VRIS SOLENOID VALVE NO.1  
B2-14

VRIS SOLENOID VALVE NO.2  
B2-15

[BLACK]  
(EM)-(E)  
X-09

[BLACK]  
(EM)-(E)  
X-07

[GRAY]  
EGR VALVE  
B2-12

IDLE AIR CONTROL VALVE  
B2-13

B2-17  
PRC SOLENOID VALVE  
[BROWN]

B2-27  
EGR BOOST SOLENOID VALVE

B2-16  
MASS AIR FLOW SENSOR

**MASS AIR FLOW SENSOR**  
Detects mass air flow amount and sends signal to PCM.

X-06  
(F)-(EM)

X-02  
(F)-(E)

B2-11  
PURGE SOLENOID VALVE  
[BLACK]

(F)-(R)  
X-10

(EM)-(I)  
X-13

B2-01  
PCM

**PCM**  
Uses information from various sensors/actuators to control powertrain (engine/transaxle) operation.

X-19  
(I)-(R)

X-13  
(EM)-(I)

(F)-(R)  
X-10

(I)-(R)  
X-19

B2-31  
CANISTER DRAIN CUT VALVE  
[BLACK]  
(NOTE ABOVE THE REAR CROSSMEMBER)

WIRING DIAGRAM Z

B-2d

Z-37

# EC-AT CONTROL SYSTEM (KL) / ENGINE CONTROL SYSTEM (KL)

B-2e

Z WIRING DIAGRAM

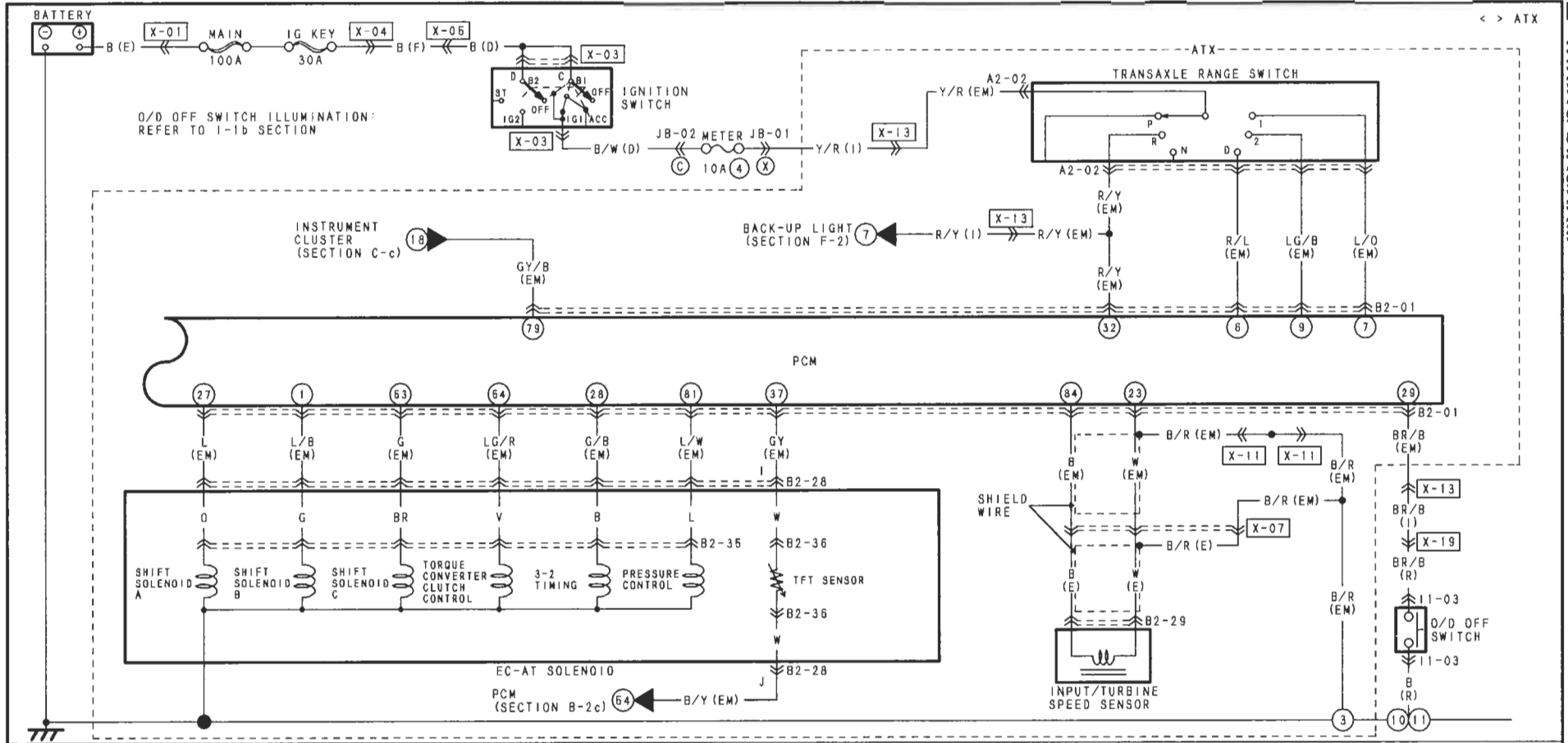

B2-01 PCM (EM)

26	25	24	23*	22	21	20	19	18	17	16	15	14	13	12	11	10	9*	8	7*	6*	6	4	3	2	1*
R	*	B/L	<W>	G	L	L/O	L/Y	LG	GY	P	L	*	V	BR/W	V/W	<LG/B>	L	<L/O>	<R/L>	P/B	*	*	BR/Y	<L/B>	
52	51	50	49	48	47	46	45	44	43	42	41	40	39	38	37*	36	35	34	33	32*	31	30	29*	28*	27*
W	B/L	*	R/W	O/B	*	P/B	L/B	W/B	*	G/D	V/R	*	G/W	O/L	<GY>	BR/R	Y	Y/B	R/B	<R/Y>	L/Y	<*>	BR/B	<G/B>	<L>
78	77	76	75	74	73	72	71	70	69	68	67	66	65	64<G>	63	62	61	60	59	58	57	56	55	54*	53*
B	B/L	B/R	L	L/R	W	R/Y	R/B	LG/R	GY/B	G	Y/L	O	* LG/B	G/Y	P/G	G	R	*	GY/L	W	O/B	L/R	<LG/R>	<G>	
104	103	102	101	100	99	98	97	96	95	94	93	92*	91	90	89	88	87	86	85	84*	83	82	81*	80	79*
*	B/L	*	L/W	V	Y/V	W/R	R/B	V/R	BR/B	W/L	BR	<W/G>	B/Y	GY/R	V/Y	R/G	B	*	P	<B>	G/R	P/B	<L/W>	SB	<GY/B>

B2-28 EMISSION (EM) - EC-AT SOLENOID

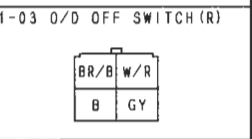
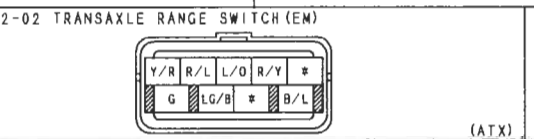
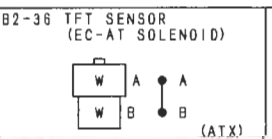
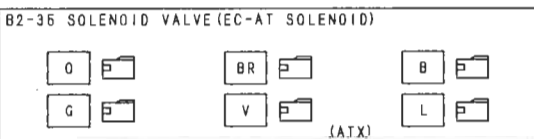
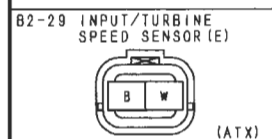
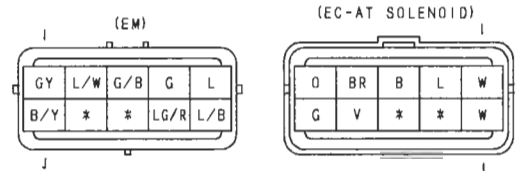

Z-38

<> ATX

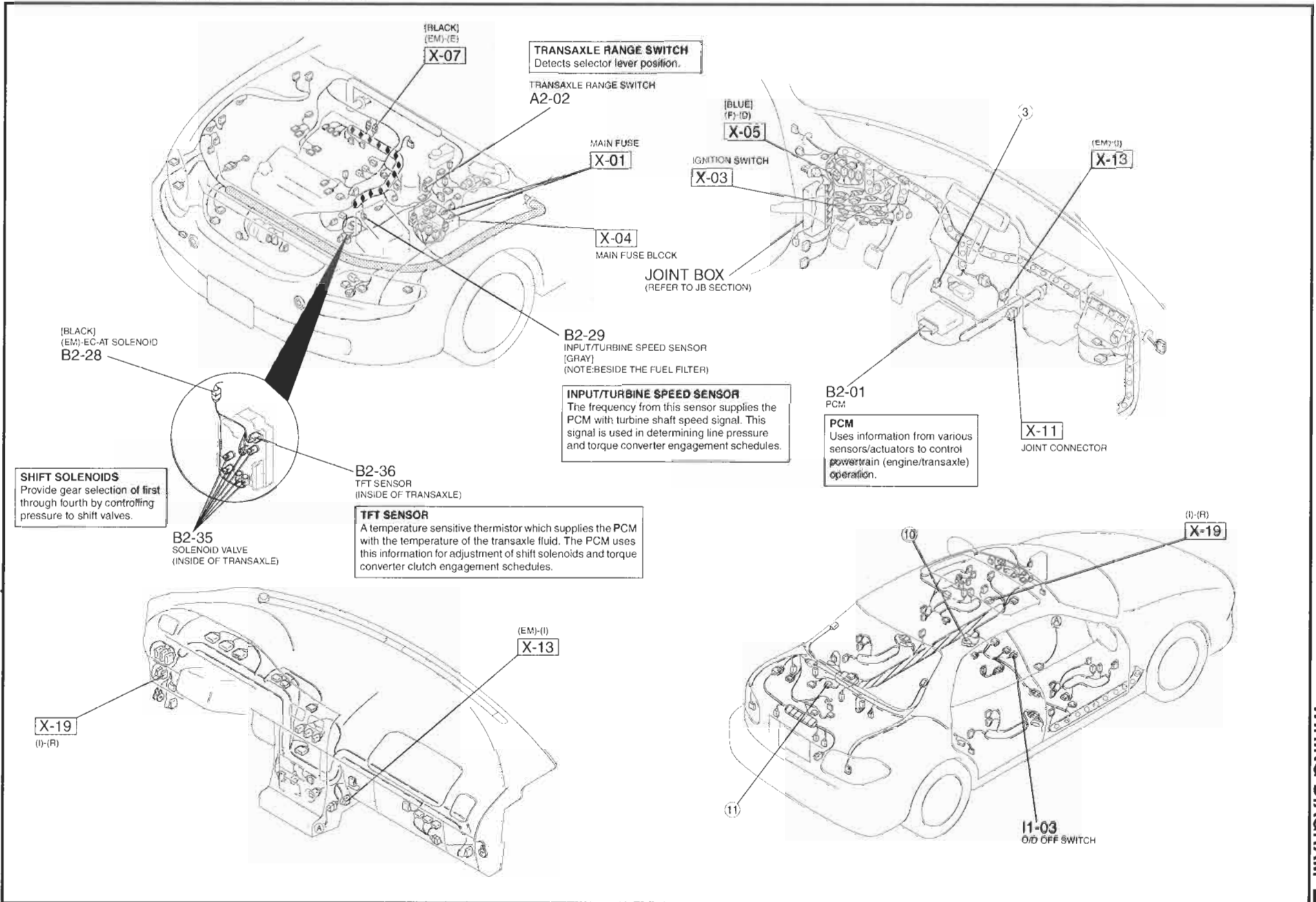

# FUEL CONTROL SYSTEM

< > WITH IMMOBILIZER SYSTEM

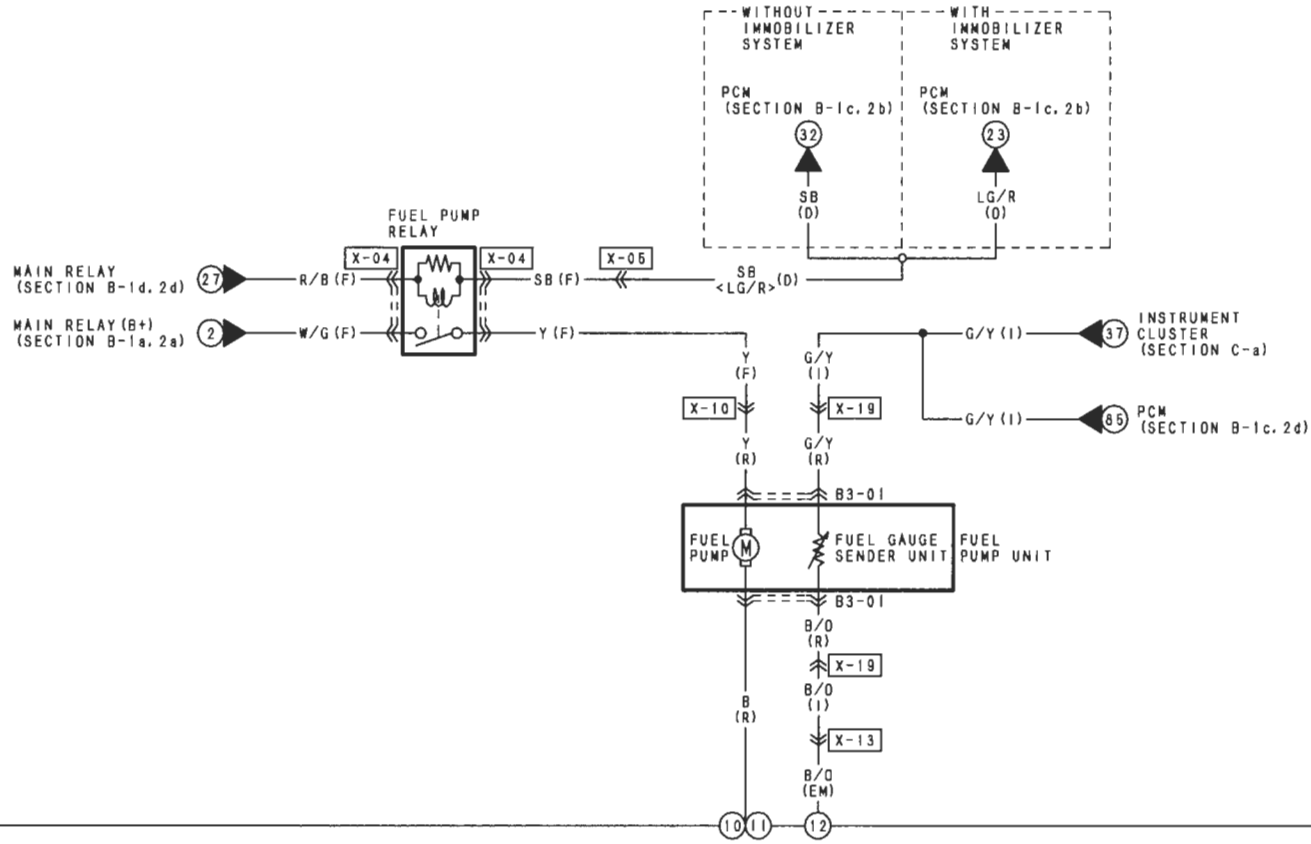

Z-40

B3-01 FUEL PUMP UNIT (R)

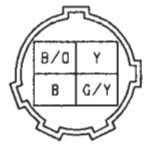

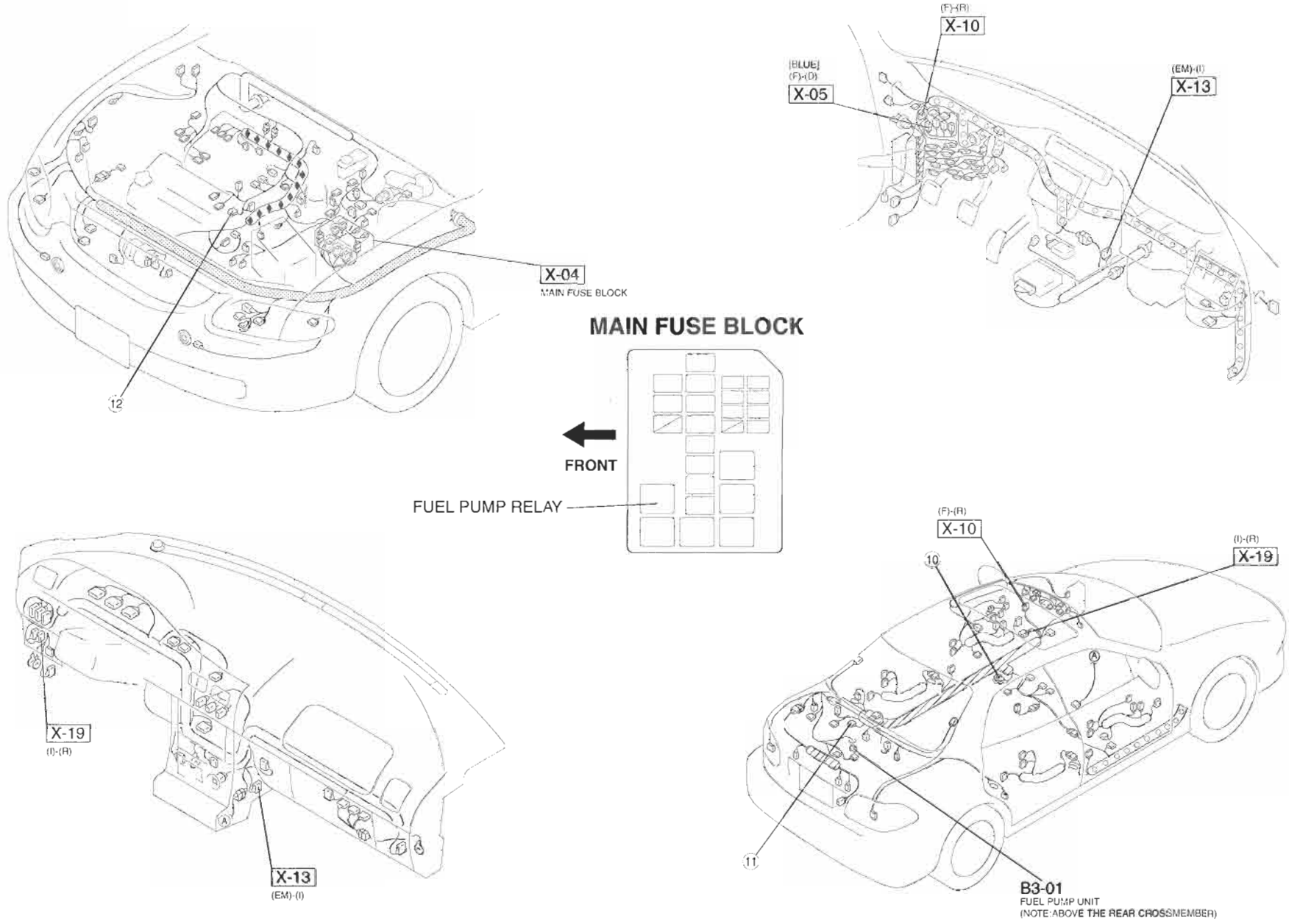

HARNESS SYMBOL :  (F)  (E)  (D)  (R)



Z-41

WIRING DIAGRAM Z

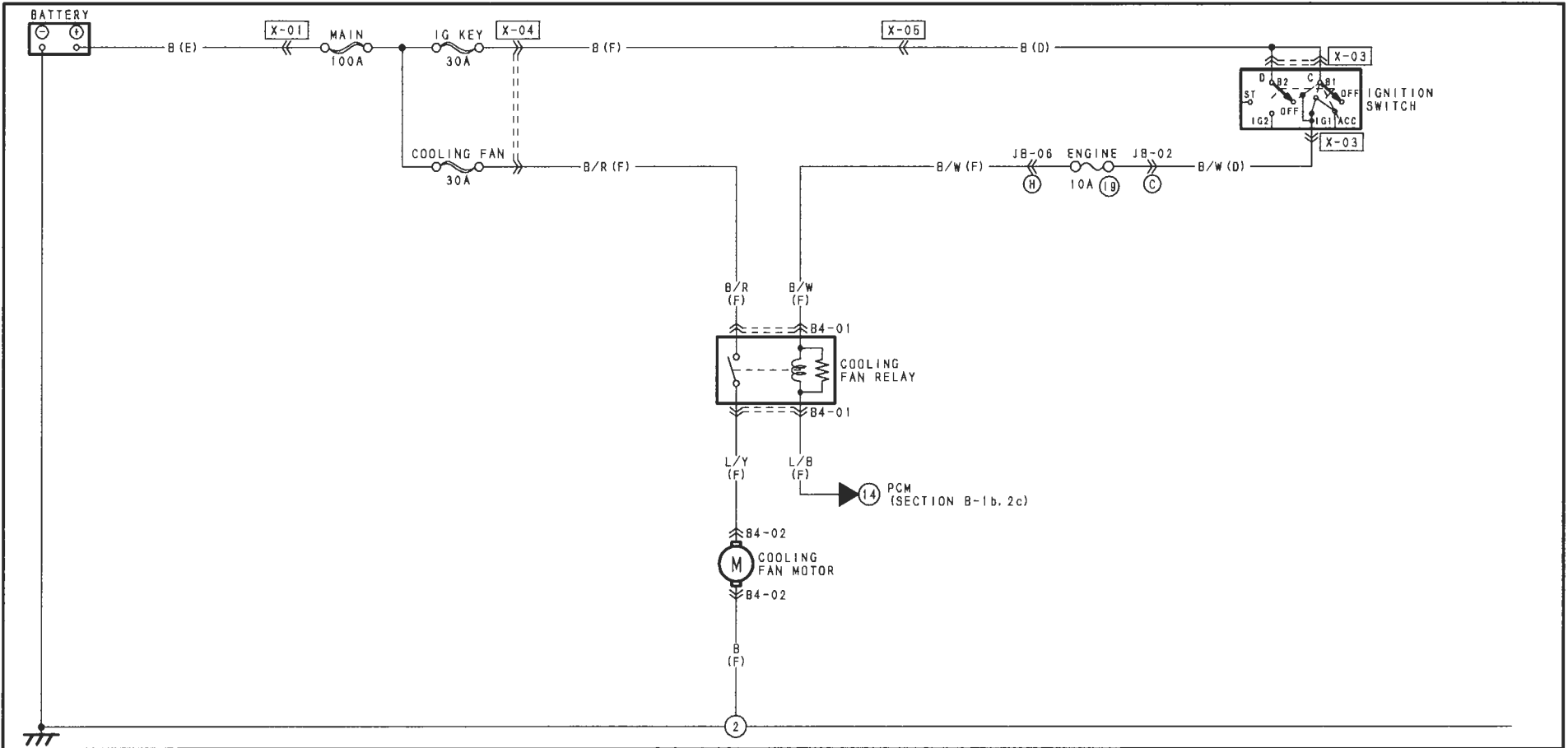
# COOLING FAN SYSTEM

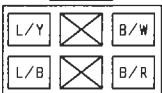
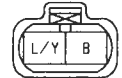

<p>B4-01 COOLING FAN RELAY (F)</p> 	<p>B4-02 COOLING FAN MOTOR (F)</p> 				

Z-42

HARNESS SYMBOL :  (F)  (E)  (D)  (R)

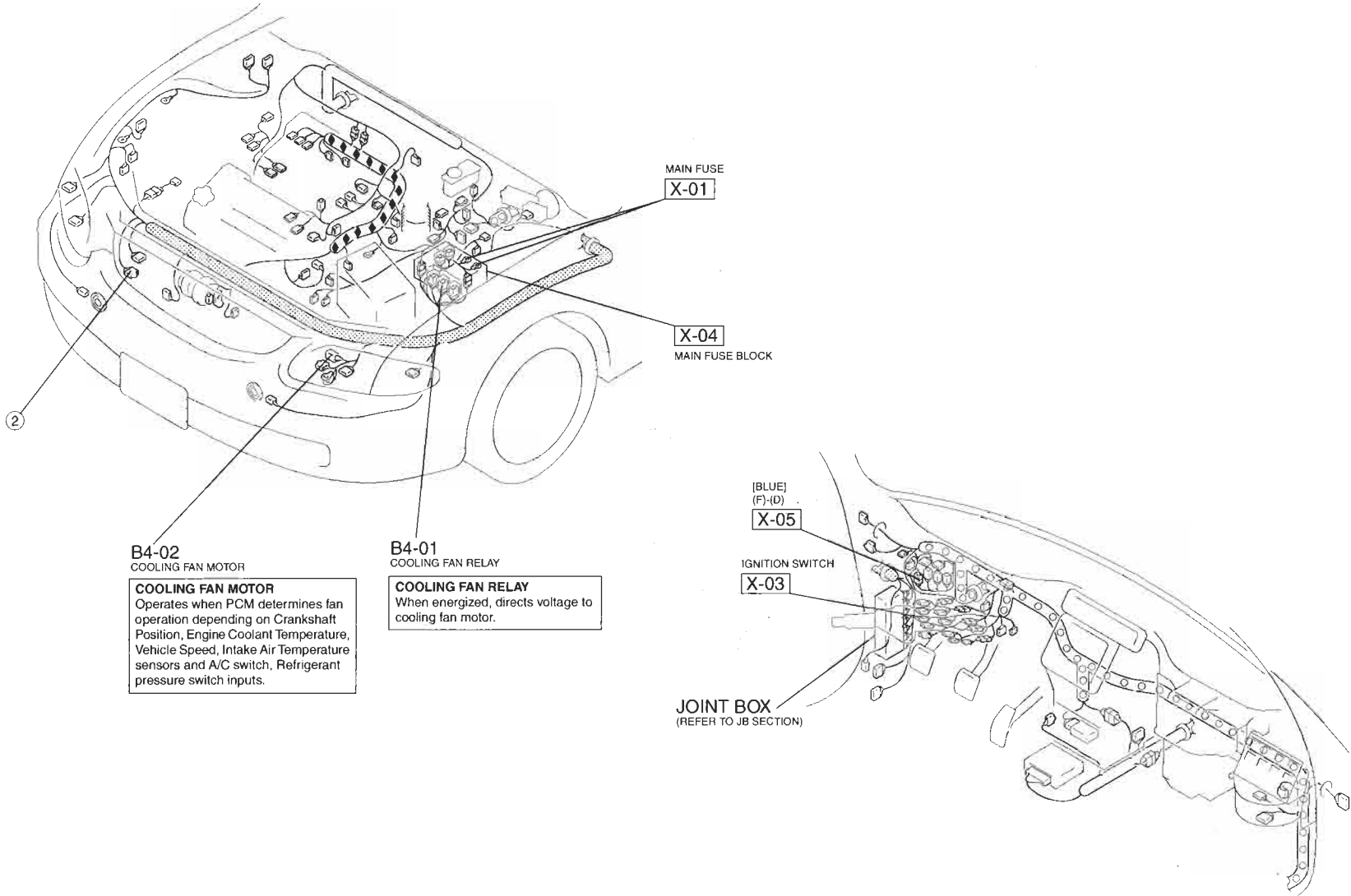

**B4-02**  
COOLING FAN MOTOR

**COOLING FAN MOTOR**  
Operates when PCM determines fan operation depending on Crankshaft Position, Engine Coolant Temperature, Vehicle Speed, Intake Air Temperature sensors and A/C switch, Refrigerant pressure switch inputs.

**B4-01**  
COOLING FAN RELAY

**COOLING FAN RELAY**  
When energized, directs voltage to cooling fan motor.

MAIN FUSE  
**X-01**

**X-04**  
MAIN FUSE BLOCK

[BLUE]  
(F)-(D)  
**X-05**

IGNITION SWITCH  
**X-03**

JOINT BOX  
(REFER TO JB SECTION)

Z-43

WIRING DIAGRAM Z

B-4